



November 13, 2017

**Via E-Mail: Joshua\_I\_williams@dekalbschoolsga.org**

Mr. Joshua L. Williams, MBA, MSM, PMP  
Chief Operations Officer  
DeKalb County School District  
Operations Division  
Sam Moss Service Center  
1780 Montreal Road  
Tucker, Georgia 30084

**Re: Summary of Additional Lead in Drinking Water Sample Results  
Chapel Hill Middle School (Facility ID #0193)  
3535 Dogwood Farm Road, Decatur, Georgia 30034  
AEM Project No. 1561-1601**

Dear Mr. Williams:

Atlanta Environmental Management, Inc. (AEM) is pleased to provide the DeKalb County School District (DCSD) an electronic copy of the Lead in Drinking Water Sample Results for Chapel Hill Middle School (Facility ID #0193). Additional drinking water samples from select source units were collected on October 27, 2017, and analytical results were received from Analytical Environmental Services, Inc., on November 9, 2017.

## **FINDINGS**

### ***Sample Results of Previously Identified Source Units That Exceeded 15 ppb***

During the initial sampling event on May 5, 2017, one source unit was sampled and the analytical results indicated that the results were above EPA's action level of 15 ppb. DCSD replaced the source unit and AEM collected two drinking water samples on October 27, 2017.

None of the samples from the source unit had a drinking water sample result that contained lead at a concentration at or above EPA's action level of 15 ppb. A description of the drinking water outlet sampled and a summary of sample analytical results are provided in Table 1.

---

Mr. Joshua Williams—DeKalb County School District  
November 13, 2017  
Page 2

We appreciate your selection of AEM for this project. If you have any questions, please do not hesitate to contact us.

Sincerely,

**Atlanta Environmental Management, Inc.**



Leona Miles, CHMM  
Senior Project Manager



Janet T. Hart  
President

/krf

cc: Daniel Drake (DCSD)  
Tracee Hill (DCSD)  
Sandra Glenn (DeKalb County Watershed Management)  
Ryan Cira (DeKalb Board of Health)

Attachment: Table

**Table 1. Summary of Lead in Drinking Water Laboratory Analytical Retest Results**

**Chapel Hill Middle School**

3535 Dogwood Farm Road, Decatur, GA 30034



Sample ID*	Sample Location Description	Sample Date & Time	Lead Test Results (ppb)
0193-102717-TL-002-A	Initial Draw sample; Retest sink in Teacher work room 175.3	10/27/17 5:19 AM	1.31
0193-102717-TL-002-B	Flush sample; Retest sink in Teacher work room 175.3	10/27/17 5:20 AM	None Detected

**Notes:**

ppb-parts per billion

**Bold**-Exceeds 15 ppb--EPA's Action Level for Lead

\* Note--Where "A" and "B" are indicated, AEM collected two samples at each source area location: ("A") initial draw sample; and ("B") after a 30-second flush sample

\*\*The source unit was initially sampled on 5/5/17 and the initial results indicated that a concentration exceeded the EPA standard of 15 ppb. The source unit was replaced by DCSD and retesting was conducted. The above summarizes the retest results.



November 17, 2017

**Via E-Mail: Joshua\_I\_williams@dekalbschoolsga.org**

Mr. Joshua L. Williams, MBA, MSM, PMP  
Chief Operations Officer  
DeKalb County School District  
Operations Division  
Sam Moss Service Center  
1780 Montreal Road  
Tucker, Georgia 30084

**Re: Final Technical Report Lead in Drinking Water Sample Results  
Chapel Hill Middle School (Facility ID #0193)  
3535 Dogwood Farm Road, Decatur, Georgia 30034  
AEM Project No. 1561-1601**

Dear Mr. Williams:

Atlanta Environmental Management, Inc. (AEM) is pleased to provide the DeKalb County School District (DCSD) an electronic copy of the Final Technical Lead in Drinking Water Sampling Report for Chapel Hill Middle School (Facility ID #0193).

Initial sampling was conducted on May 5, 2017, and analytical results were received from Analytical Environmental Services, Inc., on May 19, 2017. Additional drinking water samples from select source units were collected on October 27, 2017, and analytical results were received from Analytical Environmental Services, Inc., on November 9, 2017.

## **FINDINGS**

### ***Initial Testing***

AEM collected 68 drinking water samples from 34 sources at Chapel Hill Middle School (Facility ID #0193), including 2 duplicate samples (see Figure 1). A description of the drinking water outlets sampled and a summary of sample analytical results are provided in the attached table.

Samples were collected in accordance with the Water Sampling Methodology Protocol for DeKalb County School District, dated September 12, 2016. A copy of AEM's Field Sampling Notes is provided in Attachment A.

One of the sources sampled had a drinking water sample result that contained lead at a concentration at or above EPA's action level of 15 parts per billion (ppb). This source is indicated in bold and shaded font in the attached table. A copy of the AES laboratory analytical report is provided in Attachment B.

**Sample Results of Previously Identified Source Units That Exceeded 15 ppb**

During the initial sampling event on May 5, 2017, one source unit was sampled and the analytical results indicated that the results were above EPA's action level of 15 ppb. DCSD replaced the source unit and AEM collected two drinking water samples on October 27, 2017.

None of the samples from the source unit had a drinking water sample result that contained lead at a concentration at or above EPA's action level of 15 ppb. A description of the drinking water outlet sampled and a summary of sample analytical results are provided in Table 1.

We appreciate your selection of AEM for this project. If you have any questions, please do not hesitate to contact us.

Sincerely,

**Atlanta Environmental Management, Inc.**



Leona Miles, CHMM  
Senior Project Manager

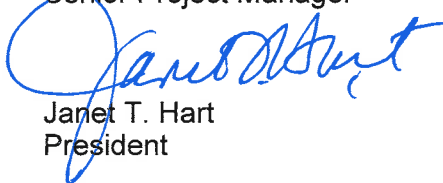

Janet T. Hart  
President

/krf

cc: Daniel Drake (DCSD)  
Tracee Hill (DCSD)

---

# FIGURE

# Legend

- Athletic Field (AF)
- Cafeteria Sink (CS)
- Drinking Fountain (DF)
- Ice Maker (IM)
- Kindergarten Sink (KS)
- Other (OT)
- Restroom Sink (RS)
- Service Connection (SC)
- Teachers Lounge (TL)

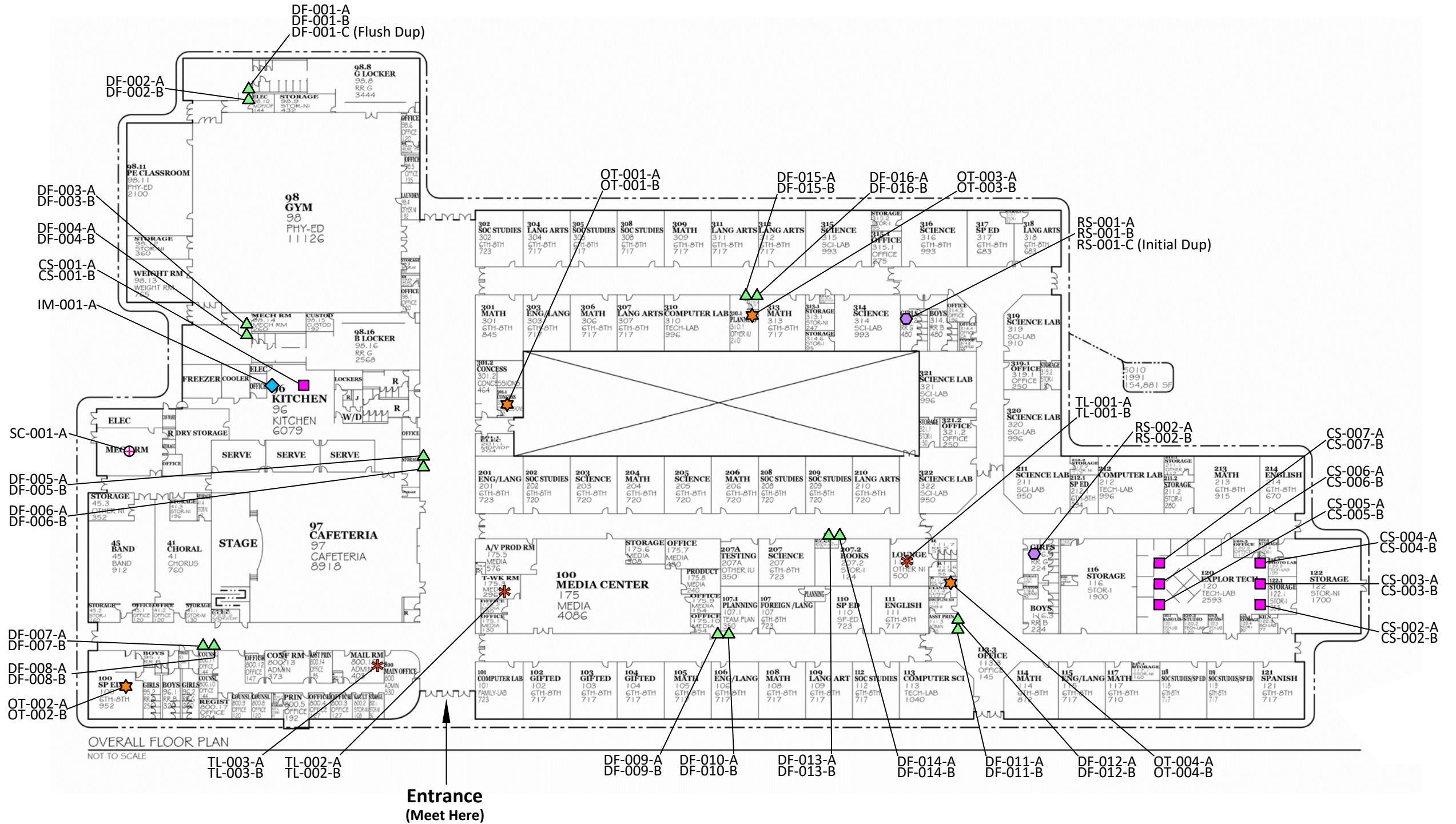

 <b>Atlanta Environmental Management, Inc.</b> Environmental Consulting, Engineering, Hydrogeologic Services 2580 Northeast Expressway • Atlanta, Georgia 30345 Phone: 404.329.9006 • Fax: 404.329.2057		Client: DeKalb County School District Site Location: Chapel Hill Middle Facility (0193) 3535 Dogwood Farm Road Decatur, GA 30034	
PROJECT #:	1561-1601-0193	DATE:	November 14, 2017
DRAWN BY:	AL	REVISED:	----
CHECKED BY:	TR	SCALE:	NTS
PROJECT MGR:	LM	PRINTED:	11/14/2017 10:59 AM
<b>Sample Location Plan</b>			Figure <b>1</b>

---

# TABLE



**Table 1. Summary of Lead in Drinking Water Laboratory Analytical Results**

**Chapel Hill Middle School**  
**3535 Dogwood Farm Road, Decatur, GA 30034**



Sample ID*	Sample Location Description	Sample Date & Time	Lead Test Results (ppb)
0193-050517-DF-001-A	Initial Draw sample; Oasis drinking fountain in Girl's locker room on North side of gym	05/5/17 5:31 AM	None Detected
0193-050517-DF-001-B	Flush sample; Oasis drinking fountain in Girl's locker room on North side of gym	05/5/17 5:32 AM	None Detected
0193-050517-DF-001-C	Flush sample duplicate; Oasis drinking fountain in Girl's locker room on North side of gym	05/5/17 5:33 AM	None Detected
0193-050517-DF-002-A	Initial Draw sample; Oasis drinking fountain in Girl's locker room on North side of gym	05/5/17 5:37 AM	None Detected
0193-050517-DF-002-B	Flush sample; Oasis drinking fountain in Gir's locker room on North side of gym	05/5/17 5:38 AM	None Detected
0193-050517-DF-003-A	Initial Draw sample; Elkay Drinking fountain in Boy's locker room on South side of gym	05/5/17 5:44 AM	None Detected
0193-050517-DF-003-B	Flush sample; Elkay Drinking fountain in Boy's locker room on South side of gym	05/5/17 5:45 AM	None Detected
0193-050517-DF-004-A	Initial Draw sample; Elkay Drinking fountain in Boy's locker room on South side of gym	05/5/17 5:48 AM	4.10
0193-050517-DF-004-B	Flush sample; Elkay Drinking fountain in Boy's locker room on South side of gym	05/5/17 5:49 AM	3.40
0193-050517-DF-005-A	Initial Draw sample; right Elkay drinking fountain outside of cafeteria; wall mounted	05/5/17 5:16 AM	None Detected
0193-050517-DF-005-B	Flush sample; right Elkay drinking fountain outside of cafeteria; wall mounted	05/5/17 5:17 AM	None Detected
0193-050517-DF-006-A	Initial Draw sample; left Elkay drinking fountain outside of cafeteria; wall mounted	05/5/17 5:20 AM	None Detected
0193-050517-DF-006-B	Flush sample; left Elkay drinking fountain outside of cafeteria; wall mounted	05/5/17 5:21 AM	None Detected
0193-050517-DF-007-A	Initial Draw sample; Upper Elkay Drinking fountain in hallway near Counselor's Office/Rm 144	05/5/17 6:20 AM	None Detected
0193-050517-DF-007-B	Flush sample; Upper Elkay Drinking fountain in hallway near Counselor's Office/Rm 144	05/5/17 6:21 AM	None Detected
0193-050517-DF-008-A	Initial Draw sample; Lower Elkay Drinking fountain in hallway near Counselor's Office/Rm 144	05/5/17 6:23 AM	1.38

**Table 1. Summary of Lead in Drinking Water Laboratory Analytical Results**

**Chapel Hill Middle School**  
**3535 Dogwood Farm Road, Decatur, GA 30034**



Sample ID*	Sample Location Description	Sample Date & Time	Lead Test Results (ppb)
0193-050517-DF-008-B	Flush sample; Lower Elkay Drinking fountain in hallway near Counselor's Office/Rm 144	05/5/17 6:24 AM	None Detected
0193-050517-DF-009-A	Initial Draw sample; Left Elkay in hallway across from Rm 106	05/5/17 6:21 AM	None Detected
0193-050517-DF-009-B	Flush sample; Left Elkay in hallway across from Rm 106	05/5/17 6:22 AM	None Detected
0193-050517-DF-010-A	Initial Draw sample; Right Elkay in hallway across from Rm 106	05/5/17 6:23 AM	None Detected
0193-050517-DF-010-B	Flush sample; Right Elkay in hallway across from Rm 106	05/5/17 6:24 AM	None Detected
0193-050517-DF-011-A	Initial Draw sample; Upper right Elkay Drinking fountain in hallway near assistant principals office	05/5/17 6:17 AM	None Detected
0193-050517-DF-011-B	Flush sample; Upper right Elkay Drinking fountain in hallway near assistant principals office	05/5/17 6:18 AM	None Detected
0193-050517-DF-012-A	Initial Draw sample; Lower left Elkay Drinking fountain in hallway near assistant principals office	05/5/17 6:15 AM	None Detected
0193-050517-DF-012-B	Flush sample; Lower left Elkay Drinking fountain in hallway near assistant principals office	05/5/17 6:16 AM	None Detected
0193-050517-DF-013-A	Initial Draw sample; Right Elkay in hallway across from Rm 206	05/5/17 6:12 AM	None Detected
0193-050517-DF-013-B	Flush sample; Right Elkay in hallway across from Rm 206	05/5/17 6:13 AM	None Detected
0193-050517-DF-014-A	Initial Draw sample; Left Elkay in hallway across from Rm 206	05/5/17 6:10 AM	None Detected
0193-050517-DF-014-B	Flush sample; Left Elkay in hallway across from Rm 206	05/5/17 6:11 AM	None Detected
0193-050517-DF-015-A	Initial Draw sample; Upper right Elkay drinking fountain in hallway near Rm 310J	05/5/17 6:06 AM	None Detected
0193-050517-DF-015-B	Flush sample; Upper right Elkay drinking fountain in hallway near Rm 310J	05/5/17 6:07 AM	None Detected
0193-050517-DF-016-A	Initial Draw sample; Lower Left Elkay drinking fountain in hallway near Rm 310J	05/5/17 6:04 AM	None Detected
0193-050517-DF-016-B	Flush sample; Lower Left Elkay drinking fountain in hallway near Rm 310J	05/5/17 6:05 AM	None Detected
0193-050517-OT-001-A	Initial Draw sample; Food prep sink in concession stand	05/5/17 5:57 AM	5.08
0193-050517-OT-001-B	Flush sample; Food prep sink in concession stand	05/5/17 5:58 AM	None Detected
0193-050517-OT-002-A	Initial Draw sample; Sink in Rm 98	05/5/17 6:14 AM	None Detected
0193-050517-OT-002-B	Flush sample; Sink in Rm 98	05/5/17 6:15 AM	None Detected

**Table 1. Summary of Lead in Drinking Water Laboratory Analytical Results**

**Chapel Hill Middle School**

**3535 Dogwood Farm Road, Decatur, GA 30034**



Sample ID*	Sample Location Description	Sample Date & Time	Lead Test Results (ppb)
0193-050517-OT-003-A	Initial Draw sample; Sink in Nurses' Clinic RR/Rm 310J	05/5/17 6:00 AM	2.93
0193-050517-OT-003-B	Flush sample; Sink in Nurses' Clinic RR/Rm 310J	05/5/17 6:01 AM	None Detected
0193-050517-OT-004-A	Initial Draw sample; Sink next to microwave in Clinic in Discipline Office	05/5/17 5:50 AM	None Detected
0193-050517-OT-004-B	Flush sample; Sink next to microwave in Clinic in Discipline Office	05/5/17 5:51 AM	None Detected
0193-050517-CS-001-A	Initial Draw sample; Food prep sink on far back wall of kitchen	05/5/17 5:08 AM	None Detected
0193-050517-CS-001-B	Flush sample; Food prep sink on far back wall of kitchen	05/5/17 5:09 AM	None Detected
0193-050517-CS-002-A	Initial Draw sample; Front right sink in Family and Consumer Science Rm 120	05/5/17 5:18 AM	3.28
0193-050517-CS-002-B	Flush sample; Front right sink in Family and Consumer Science Rm 120	05/5/17 5:19 AM	None Detected
0193-050517-CS-003-A	Initial Draw sample; Middle right sink in Family and Consumer Science Rm 120	05/5/17 5:20 AM	2.36
0193-050517-CS-003-B	Flush sample; Middle right sink in Family and Consumer Science Rm 120	05/5/17 5:21 AM	None Detected
0193-050517-CS-004-A	Initial Draw sample; Back right sink in Family and Consumer Science Rm 120	05/5/17 5:22 AM	4.08
0193-050517-CS-004-B	Flush sample; Back right sink in Family and Consumer Science Rm 120	05/5/17 5:23 AM	None Detected
0193-050517-CS-005-A	Initial Draw sample; Front left sink in Family and Consumer Science Rm 120	05/5/17 5:24 AM	6.34
0193-050517-CS-005-B	Flush sample; Front left sink in Family and Consumer Science Rm 120	05/5/17 5:25 AM	None Detected
0193-050517-CS-006-A	Initial Draw sample; Middle left sink in Family and Consumer Science Rm 120	05/5/17 5:26 AM	1.52
0193-050517-CS-006-B	Flush sample; Middle left sink in Family and Consumer Science Rm 120	05/5/17 5:27 AM	None Detected
0193-050517-CS-007-A	Initial Draw sample; Back left sink in Family and Consumer Science Rm 120	05/5/17 5:28 AM	4.97
0193-050517-CS-007-B	Flush sample; Back left sink in Family and Consumer Science Rm 120	05/5/17 5:29 AM	None Detected
0193-050517-TL-001-A	Initial Draw sample; Sink next to microwave in Rm 110	05/5/17 5:40 AM	None Detected
0193-050517-TL-001-B	Flush sample; Sink next to microwave in Rm 110	05/5/17 5:41 AM	None Detected
0193-050517-TL-002-A	Initial Draw sample; sink in Teacher work room 175.3	05/5/17 6:04 AM	<b>39.3</b>
0193-050517-TL-002-B	Flush sample; sink in Teacher work room 175.3	05/5/17 6:05 AM	1.42
0193-102717-TL-002-A	Initial Draw sample; Retest sink in Teacher work room 175.3	10/27/17 5:19 AM	1.31
0193-102717-TL-002-B	Flush sample; Retest sink in Teacher work room 175.3	10/27/17 5:20 AM	None Detected
0193-050517-TL-003-A	Initial Draw sample; Sink in Mail Room	05/5/17 6:09 AM	None Detected
0193-050517-TL-003-B	Flush sample; Sink in Mail Room	05/5/17 6:10 AM	None Detected
0193-050517-RS-001-A	Initial Draw sample; Leftmost Sink in Gir'ls RR, across from Rm 316	05/5/17 5:52 AM	None Detected
0193-050517-RS-001-B	Flush sample; Leftmost Sink in Gir'ls RR across from Rm 316	05/5/17 5:54 AM	None Detected
0193-050517-RS-001-C	Initial duplicate sample; Leftmost Sink in Gir'ls RR across from Rm 316	05/5/17 5:53 AM	None Detected

**Table 1. Summary of Lead in Drinking Water Laboratory Analytical Results**

**Chapel Hill Middle School**

3535 Dogwood Farm Road, Decatur, GA 30034



Sample ID*	Sample Location Description	Sample Date & Time	Lead Test Results (ppb)
0193-050517-RS-002-A	Initial Draw sample; Middle sink in Girl's RR across from Rm 211	05/5/17 5:44 AM	None Detected
0193-050517-RS-002-B	Flush sample; Middle sink in Girl's RR across from Rm 211	05/5/17 5:45 AM	None Detected
0193-050517-IM-001-A	Initial Draw sample; Ice machine in cafeteria kitchen	05/5/17 5:02 AM	None Detected
0193-050517-SC-001-A	Main Service Connection Entry into Building	05/5/17 4:53 AM	None Detected

**Notes:**

ppb-parts per billion

**Bold**-Exceeds 15 ppb--EPA's Action Level for Lead

\* Note--Where "A" and "B" are indicated, AEM collected two samples at each source area location: ("A") initial draw sample; and ("B") after a 30-second flush sample

---

**ATTACHMENT A**  
**AEM Field Sampling Forms**

**DEKALB COUNTY SCHOOL DISTRICT  
LEAD IN DRINKING WATER FIELD DATA SHEET**

FACILITY NAME: CHAPEL HILL MIDDLE FACILITY  
 ADDRESS: 3535 Dogwood Farm Road Decatur, GA, 30034

FACILITY ID: 0193

DATE	TIME	SAMPLE ID (Facility ID-Date-Location Type-Sequential #-Sample Type)	NEAREST ROOM	LOCATION (circle)	DESCRIPTION	SAMPLER INIT.
5/5/17	0453	0193 - 050517 - SC-001-A	Mecanical Room	In room Hallway	outside faucet connected to service inside mechanical room	JK
5/5/17	0502	0193 - 050517 - IM-001-A	Kitchen	In room Hallway	Kitchen	JK
5/5/17	0508	0193 - 050517 - CS-001-A	Kitchen	In room Hallway	*sink on <del>front</del> back wall with long Fax Prep sink	JK
5/5/17	0509	0193 - 050517 - CS-001-B	Kitchen	In room Hallway	Same	JK
5/5/17	0516	0193 - 050517 - DF-005-A	cafeteria	In room Hallway	ELKAY EZFS8-16	JK
5/5/17	0517	0193 - 050517 - DF-005-B	Cafeteria	In room Hallway	Same	JK
5/5/17	0520	0193 - 050517 - DF-006-A	Cafeteria	In room Hallway	ELKAY EZFS8-16	JK
5/5/17	0521	0193 - 050517 - DF-006-B	Cafeteria	In room Hallway	Same	JK
5/5/17	0531	0193 - 050517 - DF-001-A	North side Gym Locker	In room Hallway	Oasis fountain	
5/5/17	0532	0193 - 050517 - DF-001-B	Same	In room Hallway	Oasis fountain	

LOCATION TYPE: AF = athletic field; CS = cafeteria sink; DF = drinking fountain; IM = ice maker; KS = kindergarten sink; RS = restroom sink; SC = service connection; TL = teachers' lounge. SAMPLE TYPE: A = initial draw; B = flush; C = duplicate

**DEKALB COUNTY SCHOOL DISTRICT  
LEAD IN DRINKING WATER FIELD DATA SHEET**

FACILITY NAME: CHAPEL HILL MIDDLE FACILITY  
 ADDRESS: 3535 Dogwood Farm Road Decatur, GA, 30034

FACILITY ID: 0193

DATE	TIME	SAMPLE ID (Facility ID-Date-Location Type-Sequential #-Sample Type)	NEAREST ROOM	LOCATION (circle)	DESCRIPTION	SAMPLER INIT.
5/5/17	0528	0193 - 050517 - CS-007-A	Family & Consumer Science	In room Hallway	back left sink	CF
5/5/17	0529	0193 - 050517 - CS-007-B	"	In room Hallway		
5/5/17	0540	0193 - 050517 - TL-001-A	110	In room Hallway	sink next to microwave	
5/5/17	0541	0193 - 050517 - TL-001-B	"	In room Hallway		
5/5/17	0544	0193 - 050517 - RS-002-A	near 211	In room Hallway	Left most sink inoperable sampled middle sink	
5/5/17	0545	0193 - 050517 - RS-002-B	"	In room Hallway		
5/5/17	0552	0193 - 050517 - RS-001-A	near Girls RR	In room Hallway	Leftmost sink	
5/5/17	0554	0193 - 050517 - RS-001-B	316	In room Hallway	Boys' RR sinks ALL inoperable	
5/5/17	0553	0193 - 050517 - RS-001-C		In room Hallway	initial dup	
5/5/17		0193 - 050517 -		In room Hallway		

LOCATION TYPE: AF = athletic field; CS = cafeteria sink; DF = drinking fountain; IM = ice maker; KS = kindergarten sink; RS = restroom sink; SC = service connection; TL = teachers' lounge. SAMPLE TYPE: A = initial draw; B = flush; C = duplicate

**DEKALB COUNTY SCHOOL DISTRICT  
LEAD IN DRINKING WATER FIELD DATA SHEET**

FACILITY NAME: CHAPEL HILL MIDDLE FACILITY  
 ADDRESS: 3535 Dogwood Farm Road Decatur, GA, 30034

FACILITY ID: 0193

DATE	TIME	SAMPLE ID (Facility ID-Date-Location Type-Sequential #-Sample Type)	NEAREST ROOM	LOCATION (circle)	DESCRIPTION	SAMPLER INIT.
5/5/17	0533	0193 - 050517 - DF-001-C	Locker on north side of gym	In room Hallway	Fountain Oasis Flush Dup	JK
5/5/17	0537	0193 - 050517 - DF-002-A	Locker on North side of gym	In room Hallway	Oasis fountain	JK
5/5/17	0538	0193 - 050517 - DF-002-B	Locker on North side of gym	In room Hallway	Oasis fountain	JK
5/5/17	0544	0193 - 050517 - DF-003-A	South side of gym	In room Hallway	<del>Oasis</del> ELKAY fountain EZFSB-1B	JK
5/5/17	0545	0193 - 050517 - DF-003-B	South side of gym	In room Hallway	Same	JK
5/5/17	0548	0193 - 050517 - DF-004-A	Locker	In room Hallway	ELKAY fountain EZFSB-1B IC	JK
5/5/17	0549	0193 - 050517 - DF-004-B	Room	In room Hallway	Same	JK
5/5/17	0557	0193 - 050517 - OT-001-A	Cafeteria	In room Hallway	SS Food Prep Sink (Double Basin)	JK
5/5/17	0558	0193 - 050517 - OT-001-B	Cafeteria	In room Hallway	Same	JK
5/5/17	0604	0193 - 050517 - TL-002-A	Productive Room	In room Hallway	SS sink	JK

LOCATION TYPE: AF = athletic field; CS = cafeteria sink; DF = drinking fountain; IM = ice maker; KS = kindergarten sink; RS = restroom sink; SC = service connection; TL = teachers' lounge. SAMPLE TYPE: A = initial draw; B = flush; C = duplicate



**DEKALB COUNTY SCHOOL DISTRICT  
LEAD IN DRINKING WATER FIELD DATA SHEET**

FACILITY NAME: CHAPEL HILL MIDDLE FACILITY  
 ADDRESS: 3535 Dogwood Farm Road Decatur, GA, 30034

FACILITY ID: 0193

DATE	TIME	SAMPLE ID (Facility ID-Date-Location Type-Sequential #-Sample Type)	NEAREST ROOM	LOCATION (circle)	DESCRIPTION	SAMPLER INIT.
5/5/17	0605	0193 - 050517 - TL-002-B	Production Room	In room Hallway	same	↗
5/5/17	0609	0193 - 050517 - TL-003-A	mail Rm	In room Hallway	SS sink	↘
5/5/17	0610 <del>0610</del> SR	0193 - 050517 - TL-003-B	mail Rm	In room Hallway	same	↘
5/5/17	0614	0193 - 050517 - OT-002-A	Rm 98	In room Hallway	SS sink	↘
5/5/17	0615	0193 - 050517 - OT-002-B	Rm 98	In room Hallway	same	↘
5/5/17	0620	0193 - 050517 - DF-007-A	Councils office	In room Hallway	ELKAY fountain upper EZFSB-16	↘
5/5/17	0621	0193 - 050517 - DF-007-B		In room Hallway	same	↘
5/5/17	0623	0193 - 050517 - DF-008-A		In room Hallway	EZFSB-16 Lower fountain	↘
5/5/17	0624	0193 - 050517 - DF-008-B		In room Hallway	same	↘
5/5/17		0193 - 050517 -		In room Hallway		

LOCATION TYPE: AF = athletic field; CS = cafeteria sink; DF = drinking fountain; IM = ice maker; KS = kindergarten sink; RS = restroom sink; SC = service connection; TL = teachers' lounge. SAMPLE TYPE: A = initial draw; B = flush; C = duplicate

**DEKALB COUNTY SCHOOL DISTRICT  
LEAD IN DRINKING WATER FIELD DATA SHEET**

FACILITY NAME: CHAPEL HILL MIDDLE FACILITY  
 ADDRESS: 3535 Dogwood Farm Road Decatur, GA, 30034

FACILITY ID: 0193

DATE	TIME	SAMPLE ID (Facility ID-Date-Location Type-Sequential #-Sample Type)	NEAREST ROOM	LOCATION (circle)	DESCRIPTION	SAMPLER INIT.
5/5/17	0621	0193 - 050517 - DF-009-A	Across from 106	In room Hallway	left Elkay	
5/5/17	0622	0193 - 050517 - DF-009-B		In room Hallway		
5/5/17	0623	0193 - 050517 - DF-010-A		In room Hallway	Right Elkay	
5/5/17	0624	0193 - 050517 - DF-010-B		In room Hallway		
5/5/17		0193 - 050517 -		In room Hallway		
5/5/17		0193 - 050517 -		In room Hallway		
5/5/17		0193 - 050517 -		In room Hallway		
5/5/17		0193 - 050517 -		In room Hallway		
5/5/17		0193 - 050517 -		In room Hallway		
5/5/17		0193 - 050517 -		In room Hallway		

LOCATION TYPE: AF = athletic field; CS = cafeteria sink; DF = drinking fountain; IM = ice maker; KS = kindergarten sink; RS = restroom sink; SC = service connection; TL = teachers' lounge. SAMPLE TYPE: A = initial draw; B = flush; C = duplicate

**DEKALB COUNTY SCHOOL DISTRICT  
LEAD IN DRINKING WATER FIELD DATA SHEET**

FACILITY NAME: CHAPEL HILL MIDDLE FACILITY  
 ADDRESS: 3535 Dogwood Farm Road Decatur, GA, 30034

FACILITY ID: 0193

DATE	TIME	SAMPLE ID (Facility ID-Date-Location Type-Sequential #-Sample Type)	NEAREST ROOM	LOCATION (circle)	DESCRIPTION	SAMPLER INIT.
5/5/17	0610	0193 - 050517 - DF-014-A	Across from 206	In room <u>Hallway</u>	Left Elkay	
5/5/17	0611	0193 - 050517 - DF-014-B	"	In room <u>Hallway</u>	"	
5/5/17	0612	0193 - 050517 - DF-013-A	"	In room <u>Hallway</u>	Right Elkay	
5/5/17	0613	0193 - 050517 - DF-013-B	"	In room <u>Hallway</u>	"	
5/5/17	0615	0193 - 050517 - DF-012-A	near Asst Principal Discipline office	In room <u>Hallway</u>	Lower left Elkay	
5/5/17	0616	0193 - 050517 - DF-012-B	"	In room <u>Hallway</u>	"	
5/5/17	0617	0193 - 050517 - DF-011-A	"	In room <u>Hallway</u>	Upper Right Elkay	
5/5/17	0618	0193 - 050517 - DF-011-B	"	In room <u>Hallway</u>	"	
5/5/17		0193 - 050517 -		In room Hallway		
5/5/17		0193 - 050517 -		In room Hallway		

LOCATION TYPE: AF = athletic field; CS = cafeteria sink; DF = drinking fountain; IM = ice maker; KS = kindergarten sink; RS = restroom sink; SC = service connection; TL = teachers' lounge. SAMPLE TYPE: A = initial draw; B = flush; C = duplicate

**DEKALB COUNTY SCHOOL DISTRICT  
LEAD IN DRINKING WATER FIELD DATA SHEET**

FACILITY NAME: CHAPEL HILL MIDDLE FACILITY  
 ADDRESS: 3535 Dogwood Farm Road Decatur, GA, 30034

FACILITY ID: 0193

DATE	TIME	SAMPLE ID (Facility ID-Date-Location Type-Sequential #-Sample Type)	NEAREST ROOM	LOCATION (circle)	DESCRIPTION	SAMPLER INIT.
5/5/17	0550	0193 - 050517 - <del>OT</del> -004-A	Clinic in Discipline office	In room Hallway	sink next to microwave	
5/5/17	0551	0193 - 050517 - <del>OT</del> -004-B		In room Hallway		
5/5/17	0600	0193 - 050517 - OT-003-A	Math Plan Rm/ Nurses' Clinic	In room Hallway	Sink in Nurses' Clinic RR	
5/5/17	0601	0193 - 050517 - OT-003-B	310J	In room Hallway		
5/5/17	0604	0193 - 050517 - DF-016-A	next to 310J	In room Hallway	Lower left Elkay	
5/5/17	0605	0193 - 050517 - DF-016-B	"	In room Hallway		
5/5/17	0606	0193 - 050517 - DF-015-A	"	In room Hallway	Upper right Elkay	
5/5/17	0607	0193 - 050517 - DF-015-B	"	In room Hallway		
5/5/17		0193 - 050517 -		In room Hallway		
5/5/17		0193 - 050517 -		In room Hallway		

LOCATION TYPE: AF = athletic field; CS = cafeteria sink; DF = drinking fountain; IM = ice maker; KS = kindergarten sink; RS = restroom sink; SC = service connection; TL = teachers' lounge. SAMPLE TYPE: A = initial draw; B = flush; C = duplicate

**DEKALB COUNTY SCHOOL DISTRICT  
LEAD IN DRINKING WATER FIELD DATA SHEET**

FACILITY NAME: CHAPEL HILL MIDDLE FACILITY  
 ADDRESS: 3535 Dogwood Farm Road Decatur, GA, 30034

FACILITY ID: 0193

DATE	TIME	SAMPLE ID (Facility ID-Date-Location Type-Sequential #-Sample Type)	NEAREST ROOM	LOCATION (circle)	DESCRIPTION	SAMPLER INIT.
5/5/17	0518	0193 - 050517 - CS-002-A	Family P Consumer Science 120	In room Hallway	Front right sink	
5/5/17	0519	0193 - 050517 - CS-002-B	"	In room Hallway	"	
5/5/17	0520	0193 - 050517 - CS-003-A	"	In room Hallway	middle right sink	
5/5/17	0521	0193 - 050517 - CS-003-B	"	In room Hallway	"	
5/5/17	0522	0193 - 050517 - CS-004-A	"	In room Hallway	back right sink	
5/5/17	0523	0193 - 050517 - CS-004-B	"	In room Hallway	"	
5/5/17	0524	0193 - 050517 - CS-005-A	"	In room Hallway	Front left sink	
5/5/17	0525	0193 - 050517 - CS-005-B	"	In room Hallway	"	
5/5/17	0526	0193 - 050517 - CS-006-A	"	In room Hallway	Middle left sink	
5/5/17	0527	0193 - 050517 - CS-006-B	"	In room Hallway	"	

LOCATION TYPE: AF = athletic field; CS = cafeteria sink; DF = drinking fountain; IM = ice maker; KS = kindergarten sink; RS = restroom sink; SC = service connection; TL = teachers' lounge. SAMPLE TYPE: A = initial draw; B = flush; C = duplicate

**DEKALB COUNTY SCHOOL DISTRICT  
LEAD IN DRINKING WATER FIELD DATA SHEET**

FACILITY NAME: CHAPEL HILL MIDDLE FACILITY  
 ADDRESS: 3535 Dogwood Farm Road Decatur, GA, 30034

FACILITY ID: 0193

DATE	TIME	SAMPLE ID (Facility ID-Date-Location Type-Sequential #-Sample Type)	NEAREST ROOM	LOCATION (circle)	DESCRIPTION	SAMPLER INIT.
10/27/17	0519	0193 - 102717 - TL-002-A	Media Center	In room Hallway	Sink in work room behind desk	
10/27/17	0520	0193 - 102717 - TL-002-B	Media Center	In room Hallway	" " " Flush	
10/27/17		0193 - 102717 -		In room Hallway		
10/27/17		0193 - 102717 -		In room Hallway		
10/27/17		0193 - 102717 -		In room Hallway		
10/27/17		0193 - 102717 -		In room Hallway		
10/27/17		0193 - 102717 -		In room Hallway		
10/27/17		0193 - 102717 -		In room Hallway		
10/27/17		0193 - 102717 -		In room Hallway		
10/27/17		0193 - 102717 -		In room Hallway		

LOCATION TYPE: AF = athletic field; CS = cafeteria sink; DF = drinking fountain; IM = ice maker; KS = kindergarten sink; RS = restroom sink; SC = service connection; TL = teachers' lounge. SAMPLE TYPE: A = initial draw; B = flush; C = duplicate

---

**ATTACHMENT B**  
**AES Laboratory Analytical Report**

## Leona Miles

---

**From:** NoReply@aesatlanta.net  
**Sent:** Friday, May 19, 2017 4:18 PM  
**To:** leona-miles@aem-net.com; tim-royer@aem-net.com  
**Subject:** DCSD - 0193  
**Attachments:** 1705525\_REPORT.pdf; 1705525Invoice.pdf

Please see attached. If you have any questions or need further assistance please contact your project manager at 770-457-8177.

AES Reporting System

ANALYTICAL ENVIRONMENTAL SERVICES, INC.  
3080 Presidential Drive ATLANTA, GA 30340  
Tel:770-457-8177 Fax:770-457-8188  
<http://www.aesatlanta.com>

NOTICE OF CONFIDENTIALITY: The information in this email and / or attachments may be legally privileged and is confidential information intended for the use of the individual or entity named in the email address. If the reader of this message is not the intended recipient, you are hereby notified that any use, dissemination, distribution, or copy of this email and / or attachments is strictly prohibited. If you have received this email in error, please notify Analytical Environmental Services Customer Service by telephone at (770) 457-8177 or by email at [info@aesatlanta.com](mailto:info@aesatlanta.com) <<mailto:info@aesatlanta.com>> and delete the message. Thank you





**ANALYTICAL ENVIRONMENTAL SERVICES, INC.**

May 19, 2017

Leona Miles  
Atlanta Environmental Mgmt  
2580 NE Expressway  
Atlanta GA 30345

TEL: (404) 329-9006  
FAX: (404) 329-2057

RE: DCSD - 0193

Dear Leona Miles:

Order No: 1705525

Analytical Environmental Services, Inc. received **68** samples on 5/5/2017 8:55:00 AM for the analyses presented in following report.

No problems were encountered during the analyses. Additionally, all results for the associated Quality Control samples were within EPA and/or AES established limits. Any discrepancies associated with the analyses contained herein will be noted and submitted in the form of a project Case Narrative.

AES's accreditations are as follows:

-NELAC/Florida State Laboratory ID E87582 for analysis of Non-Potable Water, Solid & Chemical Materials, and Drinking Water Microbiology, effective 07/01/16-06/30/17.

State of Georgia, Department of Natural Resources ID #800 for analysis of Drinking Water Metals, effective 07/01/16-06/30/17 and Total Coliforms and E. coli, effective 04/25/17-04/24/20.

-NELAC/Louisiana Agency Interest No. 100818 for or analysis of Non-Potable Water and Solid & Chemical Materials, effective 07/01/16-06/30/17.

-AIHA-LAP, LLC Laboratory ID: 100671 for Industrial Hygiene samples (Organics, Metals, PCM Asbestos, Gravimetric), Environmental Lead (Paint, Soil, Dust Wipes, Air), and

Ioana Pacurar  
Project Manager



**ANALYTICAL ENVIRONMENTAL SERVICES, INC**  
 3080 Presidential Drive, Atlanta GA 30340-3704  
 TEL.: (770) 457-8177 / TOLL-FREE (800) 972-4889 / FAX: (770) 457-8188

**CHAIN OF CUSTODY**

Work Order: 1705535

Date: 5/5/17 Page 1 of 5

COMPANY: <b>Atlanta Environmental Management, Inc</b>		ADDRESS: <b>2580 Northeast Expressway, NE Atlanta, GA 30345</b>					ANALYSIS REQUESTED												Visit our website <a href="http://www.aesatlanta.com">www.aesatlanta.com</a> to check on the status of your results, place bottle orders, etc.	No # of Containers	
PHONE: (404) 329-9006		FAX: (404) 329-2057					Total Pb Method 200.8														
SAMPLED BY: <u>C. Jackson, T. Lawrence</u>		SIGNATURE: <i>[Signature]</i>						PRESERVATION (See codes)													

#	SAMPLE ID	SAMPLED		Grab	Composite	Matrix (See codes)	I													REMARKS
		DATE	TIME					PRESERVATION (See codes)												
1	0193-050517-DF-001-A	5/5/2017	0531	X		DW	X													
2	0193-050517-DF-001-B	5/5/2017	0532	X		DW	X													
3	0193-050517-DF-001-C	5/5/2017	0533	X		DW	X													
4	0193-050517-DF-002-A	5/5/2017	0537	X		DW	X													
5	0193-050517-DF-002-B	5/5/2017	0538	X		DW	X													
6	0193-050517-DF-003-A	5/5/2017	0544	X		DW	X													
7	0193-050517-DF-003-B	5/5/2017	0545	X		DW	X													
8	0193-050517-DF-004-A	5/5/2017	0548	X		DW	X													
9	0193-050517-DF-004-B	5/5/2017	0549	X		DW	X													
10	0193-050517-DF-005-A	5/5/2017	0516	X		DW	X													
11	0193-050517-DF-005-B	5/5/2017	0517	X		DW	X													
12	0193-050517-DF-006-A	5/5/2017	0520	X		DW	X													
13	0193-050517-DF-006-B	5/5/2017	0521	X		DW	X													
14	0193-050517-DF-007-A	5/5/2017	0620	X		DW	X													
15	0193-050517-DF-007-B	5/5/2017	0621	X		DW	X													

RELINQUISHED BY	DATE/TIME	DATE/TIME	PROJECT INFORMATION			RECEIPT	
1: <i>[Signature]</i>	5/5/17 8:55A	1: <i>[Signature]</i> 5/5/17 855	PROJECT NAME: <b>DCSD</b>			Total # of Containers	
2: <i>[Signature]</i>			PROJECT #: <b>1561-1601</b>			Turnaround Time Request <input type="radio"/> Standard 5 Business Days <input type="radio"/> 2 Business Day Rush <input type="radio"/> Next Business Day Rush <input type="radio"/> Same Day Rush (auth req.) <input checked="" type="radio"/> Other: 10 business Days	
3:			SITE ADDRESS: <b>0193</b>				
			SEND REPORT TO: <b>Leona Miles and Tim Royer</b>				
SPECIAL INSTRUCTIONS/COMMENTS: Preserve at the Lab per protocol		SHIPMENT METHOD OUT / / VIA: IN / / VIA: <input checked="" type="radio"/> CLIENT FedEx UPS MAIL COURIER <input type="radio"/> GREYHOUND OTHER _____			INVOICE TO: (IF DIFFERENT FROM ABOVE)  leona-miles@aem-net.com; tim-royer@aem-net.com QUOTE #: _____ PO#: _____		
					STATE PROGRAM (if any): _____ E-mail? Y/N: _____ Fax? Y/N _____ DATA PACKAGE: <input type="radio"/> I <input type="radio"/> II <input type="radio"/> III <input type="radio"/> IV		

SAMPLES RECEIVED AFTER 3PM OR SATURDAY ARE CONSIDERED AS RECEIVED ON THE NEXT BUSINESS DAY; IF NO TAT IS MARKED ON COC AES WILL PROCEED AS STANDARD TAT.  
 SAMPLES ARE DISPOSED OF 30 DAYS AFTER COMPLETION OF REPORT UNLESS OTHER ARRANGEMENTS ARE MADE.

MATRIX CODES: A = Air GW = Groundwater SE = Sediment SO = Soil SW = Surface Water DW = Drinking Water W = Water (BlanDF) O = Other (specify)  
 PRESERVATIVE CODES: H+I = Hydrochloric acid + ice I = Ice only N = Nitric acid S+I = Sulfuric acid + ice S/M+I = Sodium Bisulfate/Methanol + ice O = Other (specify) NA = None



ANALYTICAL ENVIRONMENTAL SERVICES, INC

3080 Presidential Drive, Atlanta GA 30340-3704
TEL.: (770) 457-8177 / TOLL-FREE (800) 972-4889 / FAX: (770) 457-8188

CHAIN OF CUSTODY

Work Order: 1705585

Date: 5/5/17 Page 2 of 5

Form containing company information, sample list with columns for sample ID, date, time, grab/composite/matrix, analysis requested, and remarks. Includes sections for 'RELINQUISHED BY', 'RECEIVED BY', 'PROJECT INFORMATION', and 'SPECIAL INSTRUCTIONS/COMMENTS'.

MATRIX CODES: A = Air GW = Groundwater SE = Sediment SO = Soil SW = Surface Water DW=Drinking Water W = Water (BlanDF) O = Other (specify)
PRESERVATIVE CODES: H+I = Hydrochloric acid + ice I = Ice only N = Nitric acid S+I = Sulfuric acid + ice S/M+I = Sodium Bisulfate/Methanol + ice O = Other (specify) NA = None



ANALYTICAL ENVIRONMENTAL SERVICES, INC

3080 Presidential Drive, Atlanta GA 30340-3704
TEL.: (770) 457-8177 / TOLL-FREE (800) 972-4888 / FAX: (770) 457-8188

CHAIN OF CUSTODY

Work Order: 1705525

Date: 5/5/17 Page 3 of 5

Form containing company information, analysis requested, sample list with columns for sample ID, date, time, grab, composite, matrix, and remarks. Includes sections for relinquished/received by, project information, and shipment method.

MATRIX CODES: A = Air GW = Groundwater SE = Sediment SO = Soil SW = Surface Water DW=Drinking Water W = Water (Blanks) O = Other (specify)
PRESERVATIVE CODES: H+I = Hydrochloric acid + ice I = Ice only N = Nitric acid S+I = Sulfuric acid + ice S/M+I = Sodium Bisulfate/Methanol + ice O = Other (specify) NA = None



# ANALYTICAL ENVIRONMENTAL SERVICES, INC

3080 Presidential Drive, Atlanta GA 30340-3704  
TEL.: (770) 457-8177 / TOLL-FREE (800) 972-4889 / FAX: (770) 457-8188

## CHAIN OF CUSTODY

Work Order: 1705535

Date: 5/5/17 Page 4 of 5

COMPANY: <b>Atlanta Environmental Management, Inc</b>		ADDRESS: <b>2580 Northeast Expressway, NE Atlanta, GA 30345</b>			ANALYSIS REQUESTED										Visit our website <a href="http://www.aesatlanta.com">www.aesatlanta.com</a> to check on the status of your results, place bottle orders, etc.		No # of Containers				
PHONE: <b>(404) 329-9006</b>		FAX: <b>(404) 329-2057</b>			Total Pb Method 200.8																
SAMPLED BY: <i>C. Jackson T. Lawrence</i>		SIGNATURE: <i>[Signature]</i>			PRESERVATION (See codes)										REMARKS						
#	SAMPLE ID	SAMPLED		Grab	Composite	Matrix (See codes)	I														
		DATE	TIME																		
1	0193-050517-RS-002-B	5/5/2017	0545	X		DW	X														
2	0193-050517-CS-001-A	5/5/2017	0508	X		DW	X														
3	0193-050517-CS-001-B	5/5/2017	0509	X		DW	X														
4	0193-050517-CS-002-A	5/5/2017	0518	X		DW	X														
5	0193-050517-CS-002-B	5/5/2017	0519	X		DW	X														
6	0193-050517-CS-003-A	5/5/2017	0520	X		DW	X														
7	0193-050517-CS-003-B	5/5/2017	0521	X		DW	X														
8	0193-050517-CS-004-A	5/5/2017	0522	X		DW	X														
9	0193-050517-CS-004-B	5/5/2017	0523	X		DW	X														
10	0193-050517-CS-005-A	5/5/2017	0524	X		DW	X														
11	0193-050517-CS-005-B	5/5/2017	0525	X		DW	X														
12	0193-050517-CS-006-A	5/5/2017	0526	X		DW	X														
13	0193-050517-CS-006-B	5/5/2017	0527	X		DW	X														
14	0193-050517-CS-007-A	5/5/2017	0528	X		DW	X														
15	0193-050517-CS-007-B	5/5/2017	0529	X		DW	X														
RELINQUISHED BY		DATE/TIME		RECEIVED BY			DATE/TIME			PROJECT INFORMATION										RECEIPT	
1: <i>[Signature]</i>		5/5/17 8:55A		1: <i>[Signature]</i>			5/5/17			PROJECT NAME: <b>DCSD</b>										Total # of Containers	
2: <i>[Signature]</i>				2: <i>[Signature]</i>						PROJECT #: <b>1561-1601</b>										<input type="radio"/> Turnaround Time Request <input type="radio"/> Standard 5 Business Days <input type="radio"/> 2 Business Day Rush <input type="radio"/> Next Business Day Rush <input type="radio"/> Same Day Rush (auth req.) <input checked="" type="radio"/> Other: 10 business Days	
3: <i>[Signature]</i>				3: <i>[Signature]</i>						SITE ADDRESS: <b>0193</b>											
										SEND REPORT TO: <b>Leona Miles and Tim Royer</b>										STATE PROGRAM (if any): _____ E-mail? Y/N: _____ Fax? Y/N _____ DATA PACKAGE: I II III IV	
SPECIAL INSTRUCTIONS/COMMENTS: <b>Preserve at the Lab per protocol</b>				SHIPMENT METHOD			INVOICE TO: (IF DIFFERENT FROM ABOVE)			leona-miles@aem-net.com; tim-royer@aem-net.com											
				OUT / / VIA:						QUOTE #:										PO#:	
				IN / / VIA:																	
				CLIENT FedEx UPS MAIL COURIER																	
				GREYHOUND OTHER																	

SAMPLES RECEIVED AFTER 3PM OR SATURDAY ARE CONSIDERED AS RECEIVED ON THE NEXT BUSINESS DAY; IF NO TAT IS MARKED ON COC AES WILL PROCEED AS STANDARD TAT.  
SAMPLES ARE DISPOSED OF 30 DAYS AFTER COMPLETION OF REPORT UNLESS OTHER ARRANGEMENTS ARE MADE.



# ANALYTICAL ENVIRONMENTAL SERVICES, INC

3080 Presidential Drive, Atlanta GA 30340-3704

TEL.: (770) 457-8177 / TOLL-FREE (800) 972-4889 / FAX: (770) 457-8188

# CHAIN OF CUSTODY

Work Order: 1705525

Date: 5/5/17

Page 5 of 5

COMPANY: <b>Atlanta Environmental Management, Inc</b>		ADDRESS: <b>2580 Northeast Expressway, NE Atlanta, GA 30345</b>				ANALYSIS REQUESTED								<b>Visit our website  <a href="http://www.aesatlanta.com">www.aesatlanta.com</a>                      to check on the status of                      your results, place bottle                      orders, etc.</b>		No # of Containers			
PHONE: <b>(404) 329-9006</b>		FAX: <b>(404) 329-2057</b>				PRESERVATION (See codes)											REMARKS		
SAMPLED BY: <u>C. Jackson, T. Lawrence</u>		SIGNATURE: <u>[Signature]</u>				Total Pb Method 200.8													
#	SAMPLE ID	SAMPLED		Grab	Composite	Matrix (See codes)	I												
		DATE	TIME																
1	0193-050517-TL-001-A	5/5/2017	0540	X		DW	X												
2	0193-050517-TL-001-B	5/5/2017	0541	X		DW	X												
3	0193-050517-TL-002-A	5/5/2017	0604	X		DW	X												
4	0193-050517-TL-002-B	5/5/2017	0605	X		DW	X												
5	0193-050517-TL-002-A	5/5/2017		X		DW	X												
6	0193-050517-TL-002-B	5/5/2017		X		DW	X												
7	0193-050517-TL-003-A	5/5/2017	0609	X		DW	X												
8	0193-050517-TL-003-B	5/5/2017	0610	X		DW	X												
9	0193-050517-IM-001-A	5/5/2017	0502	X		DW	X												
10	0193-050517-SC-001-A	5/5/2017	0453	X		DW	X												
11		5/5/2017		X		DW													
12		5/5/2017		X		DW													
13		5/5/2017		X		DW													
14		5/5/2017		X		DW													
15		5/5/2017		X		DW													
RELINQUISHED BY		DATE/TIME		RECEIVED BY		DATE/TIME		PROJECT INFORMATION								RECEIPT			
1: <u>[Signature]</u>		5/5/17 8:55A		1: <u>[Signature]</u>		5/5/17 8:55A		PROJECT NAME: <b>DCSD</b>								Total # of Containers			
2: <u>[Signature]</u>				2: <u>[Signature]</u>				PROJECT #: <b>1561-1601</b>								<input type="radio"/> Turnaround Time Request <input type="radio"/> Standard 5 Business Days <input type="radio"/> 2 Business Day Rush <input type="radio"/> Next Business Day Rush <input type="radio"/> Same Day Rush (auth req.) <input checked="" type="radio"/> Other: 10 business Days			
3: <u>[Signature]</u>				3: <u>[Signature]</u>				SITE ADDRESS: <b>0193</b>								STATE PROGRAM (if any): _____			
SPECIAL INSTRUCTIONS/COMMENTS: Preserve at the Lab per protocol				SHIPMENT METHOD OUT / / VIA: IN / / VIA: CLIENT <u>(C)</u> FedEx UPS MAIL COURIER GREYHOUND OTHER _____				SEND REPORT TO: <b>Leona Miles and Tim Royer</b>								E-mail? Y/N: _____ Fax? Y/N _____			
								INVOICE TO: (IF DIFFERENT FROM ABOVE) leona-miles@aem-net.com; tim-royer@aem-net.com								DATA PACKAGE: I II III IV			
								QUOTE #: _____ PO#: _____											

SAMPLES RECEIVED AFTER 3PM OR SATURDAY ARE CONSIDERED AS RECEIVED ON THE NEXT BUSINESS DAY; IF NO TAT IS MARKED ON COC AES WILL PROCEED AS STANDARD TAT.  
 SAMPLES ARE DISPOSED OF 30 DAYS AFTER COMPLETION OF REPORT UNLESS OTHER ARRANGEMENTS ARE MADE.

MATRIX CODES: A = Air GW = Groundwater SE = Sediment SO = Soil SW = Surface Water DW=Drinking Water W = Water (Blanks) O = Other (specify)  
 PRESERVATIVE CODES: H+I = Hydrochloric acid + ice I = Ice only N = Nitric acid S+I = Sulfuric acid + ice S/M+I = Sodium Bisulfate/Methanol + ice O = Other (specify) NA = None

**Analytical Environmental Services, Inc**

**Date:** 19-May-17

<b>Client:</b> Atlanta Environmental Mgmt	<b>Client Sample ID:</b> 0193-050517-DF-001-A
<b>Project Name:</b> DCSD - 0193	<b>Collection Date:</b> 5/5/2017 5:31:00 AM
<b>Lab ID:</b> 1705525-001	<b>Matrix:</b> Drinking Water

Analyses	Result	Reporting Limit	Qual	Units	BatchID	Dilution Factor	Date Analyzed	Analyst
<b>Trace Elements by ICP/MS E200.8</b>								
				<b>(E200.2)</b>				
Lead	BRL	1.00		ug/L	242777	1	05/17/2017 17:53	JR

**Qualifiers:**

- \* Value exceeds maximum contaminant level
- BRL Below reporting limit
- H Holding times for preparation or analysis exceeded
- N Analyte not NELAC certified
- B Analyte detected in the associated method blank
- > Greater than Result value

- E Estimated (value above quantitation range)
- S Spike Recovery outside limits due to matrix
- Narr See case narrative
- NC Not confirmed
- < Less than Result value
- J Estimated value detected below Reporting Limit

**Analytical Environmental Services, Inc**

**Date:** 19-May-17

<b>Client:</b> Atlanta Environmental Mgmt	<b>Client Sample ID:</b> 0193-050517-DF-001-B
<b>Project Name:</b> DCSD - 0193	<b>Collection Date:</b> 5/5/2017 5:32:00 AM
<b>Lab ID:</b> 1705525-002	<b>Matrix:</b> Drinking Water

Analyses	Result	Reporting Limit	Qual	Units	BatchID	Dilution Factor	Date Analyzed	Analyst
<b>Trace Elements by ICP/MS E200.8</b>					<b>(E200.2)</b>			
Lead	BRL	1.00		ug/L	242777	1	05/17/2017 18:11	JR

**Qualifiers:**

- \* Value exceeds maximum contaminant level
- BRL Below reporting limit
- H Holding times for preparation or analysis exceeded
- N Analyte not NELAC certified
- B Analyte detected in the associated method blank
- > Greater than Result value

- E Estimated (value above quantitation range)
- S Spike Recovery outside limits due to matrix
- Narr See case narrative
- NC Not confirmed
- < Less than Result value
- J Estimated value detected below Reporting Limit



**Analytical Environmental Services, Inc**

**Date:** 19-May-17

<b>Client:</b> Atlanta Environmental Mgmt	<b>Client Sample ID:</b> 0193-050517-DF-001-C
<b>Project Name:</b> DCSD - 0193	<b>Collection Date:</b> 5/5/2017 5:33:00 AM
<b>Lab ID:</b> 1705525-003	<b>Matrix:</b> Drinking Water

Analyses	Result	Reporting Limit	Qual	Units	BatchID	Dilution Factor	Date Analyzed	Analyst
<b>Trace Elements by ICP/MS E200.8</b>					<b>(E200.2)</b>			
Lead	BRL	1.00		ug/L	242777	1	05/17/2017 18:14	JR

**Qualifiers:**

- \* Value exceeds maximum contaminant level
- BRL Below reporting limit
- H Holding times for preparation or analysis exceeded
- N Analyte not NELAC certified
- B Analyte detected in the associated method blank
- > Greater than Result value

- E Estimated (value above quantitation range)
- S Spike Recovery outside limits due to matrix
- Narr See case narrative
- NC Not confirmed
- < Less than Result value
- J Estimated value detected below Reporting Limit

**Analytical Environmental Services, Inc**

**Date:** 19-May-17

<b>Client:</b> Atlanta Environmental Mgmt	<b>Client Sample ID:</b> 0193-050517-DF-002-A
<b>Project Name:</b> DCSD - 0193	<b>Collection Date:</b> 5/5/2017 5:37:00 AM
<b>Lab ID:</b> 1705525-004	<b>Matrix:</b> Drinking Water

Analyses	Result	Reporting Limit	Qual	Units	BatchID	Dilution Factor	Date Analyzed	Analyst
<b>Trace Elements by ICP/MS E200.8</b>					<b>(E200.2)</b>			
Lead	BRL	1.00		ug/L	242777	1	05/17/2017 18:18	JR

**Qualifiers:**

- \* Value exceeds maximum contaminant level
- BRL Below reporting limit
- H Holding times for preparation or analysis exceeded
- N Analyte not NELAC certified
- B Analyte detected in the associated method blank
- > Greater than Result value

- E Estimated (value above quantitation range)
- S Spike Recovery outside limits due to matrix
- Narr See case narrative
- NC Not confirmed
- < Less than Result value
- J Estimated value detected below Reporting Limit

**Analytical Environmental Services, Inc**

**Date:** 19-May-17

<b>Client:</b> Atlanta Environmental Mgmt	<b>Client Sample ID:</b> 0193-050517-DF-002-B
<b>Project Name:</b> DCSD - 0193	<b>Collection Date:</b> 5/5/2017 5:38:00 AM
<b>Lab ID:</b> 1705525-005	<b>Matrix:</b> Drinking Water

Analyses	Result	Reporting Limit	Qual	Units	BatchID	Dilution Factor	Date Analyzed	Analyst
<b>Trace Elements by ICP/MS E200.8</b>					<b>(E200.2)</b>			
Lead	BRL	1.00		ug/L	242777	1	05/17/2017 18:28	JR

**Qualifiers:**

- \* Value exceeds maximum contaminant level
- BRL Below reporting limit
- H Holding times for preparation or analysis exceeded
- N Analyte not NELAC certified
- B Analyte detected in the associated method blank
- > Greater than Result value

- E Estimated (value above quantitation range)
- S Spike Recovery outside limits due to matrix
- Narr See case narrative
- NC Not confirmed
- < Less than Result value
- J Estimated value detected below Reporting Limit

**Analytical Environmental Services, Inc**

**Date:** 19-May-17

<b>Client:</b> Atlanta Environmental Mgmt	<b>Client Sample ID:</b> 0193-050517-DF-003-A
<b>Project Name:</b> DCSD - 0193	<b>Collection Date:</b> 5/5/2017 5:44:00 AM
<b>Lab ID:</b> 1705525-006	<b>Matrix:</b> Drinking Water

Analyses	Result	Reporting Limit	Qual	Units	BatchID	Dilution Factor	Date Analyzed	Analyst
<b>Trace Elements by ICP/MS E200.8</b>					<b>(E200.2)</b>			
Lead	BRL	1.00		ug/L	242777	1	05/17/2017 18:32	JR

**Qualifiers:**

- \* Value exceeds maximum contaminant level
- BRL Below reporting limit
- H Holding times for preparation or analysis exceeded
- N Analyte not NELAC certified
- B Analyte detected in the associated method blank
- > Greater than Result value

- E Estimated (value above quantitation range)
- S Spike Recovery outside limits due to matrix
- Narr See case narrative
- NC Not confirmed
- < Less than Result value
- J Estimated value detected below Reporting Limit

**Analytical Environmental Services, Inc**

**Date:** 19-May-17

<b>Client:</b> Atlanta Environmental Mgmt	<b>Client Sample ID:</b> 0193-050517-DF-003-B
<b>Project Name:</b> DCSD - 0193	<b>Collection Date:</b> 5/5/2017 5:45:00 AM
<b>Lab ID:</b> 1705525-007	<b>Matrix:</b> Drinking Water

Analyses	Result	Reporting Limit	Qual	Units	BatchID	Dilution Factor	Date Analyzed	Analyst
<b>Trace Elements by ICP/MS E200.8</b>					<b>(E200.2)</b>			
Lead	BRL	1.00		ug/L	242777	1	05/17/2017 18:35	JR

**Qualifiers:**

- \* Value exceeds maximum contaminant level
- BRL Below reporting limit
- H Holding times for preparation or analysis exceeded
- N Analyte not NELAC certified
- B Analyte detected in the associated method blank
- > Greater than Result value

- E Estimated (value above quantitation range)
- S Spike Recovery outside limits due to matrix
- Narr See case narrative
- NC Not confirmed
- < Less than Result value
- J Estimated value detected below Reporting Limit

**Analytical Environmental Services, Inc**

**Date:** 19-May-17

<b>Client:</b> Atlanta Environmental Mgmt	<b>Client Sample ID:</b> 0193-050517-DF-004-A
<b>Project Name:</b> DCSD - 0193	<b>Collection Date:</b> 5/5/2017 5:48:00 AM
<b>Lab ID:</b> 1705525-008	<b>Matrix:</b> Drinking Water

Analyses	Result	Reporting Limit	Qual	Units	BatchID	Dilution Factor	Date Analyzed	Analyst
<b>Trace Elements by ICP/MS E200.8</b>					<b>(E200.2)</b>			
Lead	4.10	1.00		ug/L	242777	1	05/17/2017 18:39	JR

**Qualifiers:**

- \* Value exceeds maximum contaminant level
- BRL Below reporting limit
- H Holding times for preparation or analysis exceeded
- N Analyte not NELAC certified
- B Analyte detected in the associated method blank
- > Greater than Result value

- E Estimated (value above quantitation range)
- S Spike Recovery outside limits due to matrix
- Narr See case narrative
- NC Not confirmed
- < Less than Result value
- J Estimated value detected below Reporting Limit

**Analytical Environmental Services, Inc**

**Date:** 19-May-17

<b>Client:</b> Atlanta Environmental Mgmt	<b>Client Sample ID:</b> 0193-050517-DF-004-B
<b>Project Name:</b> DCSD - 0193	<b>Collection Date:</b> 5/5/2017 5:49:00 AM
<b>Lab ID:</b> 1705525-009	<b>Matrix:</b> Drinking Water

Analyses	Result	Reporting Limit	Qual	Units	BatchID	Dilution Factor	Date Analyzed	Analyst
<b>Trace Elements by ICP/MS E200.8</b>					<b>(E200.2)</b>			
Lead	3.40	1.00		ug/L	242777	1	05/17/2017 18:42	JR

**Qualifiers:**

- \* Value exceeds maximum contaminant level
- BRL Below reporting limit
- H Holding times for preparation or analysis exceeded
- N Analyte not NELAC certified
- B Analyte detected in the associated method blank
- > Greater than Result value

- E Estimated (value above quantitation range)
- S Spike Recovery outside limits due to matrix
- Narr See case narrative
- NC Not confirmed
- < Less than Result value
- J Estimated value detected below Reporting Limit

**Analytical Environmental Services, Inc**

**Date:** 19-May-17

<b>Client:</b> Atlanta Environmental Mgmt	<b>Client Sample ID:</b> 0193-050517-DF-005-A
<b>Project Name:</b> DCSD - 0193	<b>Collection Date:</b> 5/5/2017 5:16:00 AM
<b>Lab ID:</b> 1705525-010	<b>Matrix:</b> Drinking Water

Analyses	Result	Reporting Limit	Qual	Units	BatchID	Dilution Factor	Date Analyzed	Analyst
<b>Trace Elements by ICP/MS E200.8</b>					<b>(E200.2)</b>			
Lead	BRL	1.00		ug/L	242777	1	05/17/2017 18:46	JR

**Qualifiers:**

- \* Value exceeds maximum contaminant level
- BRL Below reporting limit
- H Holding times for preparation or analysis exceeded
- N Analyte not NELAC certified
- B Analyte detected in the associated method blank
- > Greater than Result value

- E Estimated (value above quantitation range)
- S Spike Recovery outside limits due to matrix
- Narr See case narrative
- NC Not confirmed
- < Less than Result value
- J Estimated value detected below Reporting Limit



**Analytical Environmental Services, Inc**

**Date:** 19-May-17

<b>Client:</b> Atlanta Environmental Mgmt	<b>Client Sample ID:</b> 0193-050517-DF-005-B
<b>Project Name:</b> DCSD - 0193	<b>Collection Date:</b> 5/5/2017 5:17:00 AM
<b>Lab ID:</b> 1705525-011	<b>Matrix:</b> Drinking Water

Analyses	Result	Reporting Limit	Qual	Units	BatchID	Dilution Factor	Date Analyzed	Analyst
<b>Trace Elements by ICP/MS E200.8</b>					<b>(E200.2)</b>			
Lead	BRL	1.00		ug/L	242777	1	05/17/2017 18:03	JR

**Qualifiers:**

- \* Value exceeds maximum contaminant level
- BRL Below reporting limit
- H Holding times for preparation or analysis exceeded
- N Analyte not NELAC certified
- B Analyte detected in the associated method blank
- > Greater than Result value

- E Estimated (value above quantitation range)
- S Spike Recovery outside limits due to matrix
- Narr See case narrative
- NC Not confirmed
- < Less than Result value
- J Estimated value detected below Reporting Limit

**Analytical Environmental Services, Inc**

**Date:** 19-May-17

<b>Client:</b> Atlanta Environmental Mgmt	<b>Client Sample ID:</b> 0193-050517-DF-006-A
<b>Project Name:</b> DCSD - 0193	<b>Collection Date:</b> 5/5/2017 5:20:00 AM
<b>Lab ID:</b> 1705525-012	<b>Matrix:</b> Drinking Water

Analyses	Result	Reporting Limit	Qual	Units	BatchID	Dilution Factor	Date Analyzed	Analyst
<b>Trace Elements by ICP/MS E200.8</b>					<b>(E200.2)</b>			
Lead	BRL	1.00		ug/L	242777	1	05/17/2017 18:49	JR

**Qualifiers:**

- \* Value exceeds maximum contaminant level
- BRL Below reporting limit
- H Holding times for preparation or analysis exceeded
- N Analyte not NELAC certified
- B Analyte detected in the associated method blank
- > Greater than Result value

- E Estimated (value above quantitation range)
- S Spike Recovery outside limits due to matrix
- Narr See case narrative
- NC Not confirmed
- < Less than Result value
- J Estimated value detected below Reporting Limit

**Analytical Environmental Services, Inc**

**Date:** 19-May-17

<b>Client:</b> Atlanta Environmental Mgmt	<b>Client Sample ID:</b> 0193-050517-DF-006-B
<b>Project Name:</b> DCSD - 0193	<b>Collection Date:</b> 5/5/2017 5:21:00 AM
<b>Lab ID:</b> 1705525-013	<b>Matrix:</b> Drinking Water

Analyses	Result	Reporting Limit	Qual	Units	BatchID	Dilution Factor	Date Analyzed	Analyst
<b>Trace Elements by ICP/MS E200.8</b>					<b>(E200.2)</b>			
Lead	BRL	1.00		ug/L	242777	1	05/17/2017 18:53	JR

**Qualifiers:**

- \* Value exceeds maximum contaminant level
- BRL Below reporting limit
- H Holding times for preparation or analysis exceeded
- N Analyte not NELAC certified
- B Analyte detected in the associated method blank
- > Greater than Result value

- E Estimated (value above quantitation range)
- S Spike Recovery outside limits due to matrix
- Narr See case narrative
- NC Not confirmed
- < Less than Result value
- J Estimated value detected below Reporting Limit

**Analytical Environmental Services, Inc**

**Date:** 19-May-17

<b>Client:</b> Atlanta Environmental Mgmt	<b>Client Sample ID:</b> 0193-050517-DF-007-A
<b>Project Name:</b> DCSD - 0193	<b>Collection Date:</b> 5/5/2017 6:20:00 AM
<b>Lab ID:</b> 1705525-014	<b>Matrix:</b> Drinking Water

Analyses	Result	Reporting Limit	Qual	Units	BatchID	Dilution Factor	Date Analyzed	Analyst
<b>Trace Elements by ICP/MS E200.8</b>					<b>(E200.2)</b>			
Lead	BRL	1.00		ug/L	242777	1	05/17/2017 18:56	JR

**Qualifiers:**

- \* Value exceeds maximum contaminant level
- BRL Below reporting limit
- H Holding times for preparation or analysis exceeded
- N Analyte not NELAC certified
- B Analyte detected in the associated method blank
- > Greater than Result value

- E Estimated (value above quantitation range)
- S Spike Recovery outside limits due to matrix
- Narr See case narrative
- NC Not confirmed
- < Less than Result value
- J Estimated value detected below Reporting Limit

**Analytical Environmental Services, Inc**

**Date:** 19-May-17

<b>Client:</b> Atlanta Environmental Mgmt	<b>Client Sample ID:</b> 0193-050517-DF-007-B
<b>Project Name:</b> DCSD - 0193	<b>Collection Date:</b> 5/5/2017 6:21:00 AM
<b>Lab ID:</b> 1705525-015	<b>Matrix:</b> Drinking Water

Analyses	Result	Reporting Limit	Qual	Units	BatchID	Dilution Factor	Date Analyzed	Analyst
<b>Trace Elements by ICP/MS E200.8</b>					<b>(E200.2)</b>			
Lead	BRL	1.00		ug/L	242777	1	05/17/2017 18:59	JR

**Qualifiers:**

- \* Value exceeds maximum contaminant level
- BRL Below reporting limit
- H Holding times for preparation or analysis exceeded
- N Analyte not NELAC certified
- B Analyte detected in the associated method blank
- > Greater than Result value

- E Estimated (value above quantitation range)
- S Spike Recovery outside limits due to matrix
- Narr See case narrative
- NC Not confirmed
- < Less than Result value
- J Estimated value detected below Reporting Limit

**Analytical Environmental Services, Inc**

**Date:** 19-May-17

<b>Client:</b> Atlanta Environmental Mgmt	<b>Client Sample ID:</b> 0193-050517-DF-008-A
<b>Project Name:</b> DCSD - 0193	<b>Collection Date:</b> 5/5/2017 6:23:00 AM
<b>Lab ID:</b> 1705525-016	<b>Matrix:</b> Drinking Water

Analyses	Result	Reporting Limit	Qual	Units	BatchID	Dilution Factor	Date Analyzed	Analyst
<b>Trace Elements by ICP/MS E200.8</b>					<b>(E200.2)</b>			
Lead	1.38	1.00		ug/L	242777	1	05/17/2017 19:10	JR

**Qualifiers:**

- \* Value exceeds maximum contaminant level
- BRL Below reporting limit
- H Holding times for preparation or analysis exceeded
- N Analyte not NELAC certified
- B Analyte detected in the associated method blank
- > Greater than Result value

- E Estimated (value above quantitation range)
- S Spike Recovery outside limits due to matrix
- Narr See case narrative
- NC Not confirmed
- < Less than Result value
- J Estimated value detected below Reporting Limit

**Analytical Environmental Services, Inc**

**Date:** 19-May-17

<b>Client:</b> Atlanta Environmental Mgmt	<b>Client Sample ID:</b> 0193-050517-DF-008-B
<b>Project Name:</b> DCSD - 0193	<b>Collection Date:</b> 5/5/2017 6:24:00 AM
<b>Lab ID:</b> 1705525-017	<b>Matrix:</b> Drinking Water

Analyses	Result	Reporting Limit	Qual	Units	BatchID	Dilution Factor	Date Analyzed	Analyst
<b>Trace Elements by ICP/MS E200.8</b>					<b>(E200.2)</b>			
Lead	BRL	1.00		ug/L	242777	1	05/17/2017 19:13	JR

**Qualifiers:**

- \* Value exceeds maximum contaminant level
- BRL Below reporting limit
- H Holding times for preparation or analysis exceeded
- N Analyte not NELAC certified
- B Analyte detected in the associated method blank
- > Greater than Result value

- E Estimated (value above quantitation range)
- S Spike Recovery outside limits due to matrix
- Narr See case narrative
- NC Not confirmed
- < Less than Result value
- J Estimated value detected below Reporting Limit

**Analytical Environmental Services, Inc**

**Date:** 19-May-17

<b>Client:</b> Atlanta Environmental Mgmt	<b>Client Sample ID:</b> 0193-050517-DF-009-A
<b>Project Name:</b> DCSD - 0193	<b>Collection Date:</b> 5/5/2017 6:21:00 AM
<b>Lab ID:</b> 1705525-018	<b>Matrix:</b> Drinking Water

Analyses	Result	Reporting Limit	Qual	Units	BatchID	Dilution Factor	Date Analyzed	Analyst
<b>Trace Elements by ICP/MS E200.8</b>					<b>(E200.2)</b>			
Lead	BRL	1.00		ug/L	242777	1	05/17/2017 19:17	JR

**Qualifiers:**

- \* Value exceeds maximum contaminant level
- BRL Below reporting limit
- H Holding times for preparation or analysis exceeded
- N Analyte not NELAC certified
- B Analyte detected in the associated method blank
- > Greater than Result value

- E Estimated (value above quantitation range)
- S Spike Recovery outside limits due to matrix
- Narr See case narrative
- NC Not confirmed
- < Less than Result value
- J Estimated value detected below Reporting Limit



**Analytical Environmental Services, Inc**

**Date:** 19-May-17

<b>Client:</b> Atlanta Environmental Mgmt	<b>Client Sample ID:</b> 0193-050517-DF-009-B
<b>Project Name:</b> DCSD - 0193	<b>Collection Date:</b> 5/5/2017 6:22:00 AM
<b>Lab ID:</b> 1705525-019	<b>Matrix:</b> Drinking Water

Analyses	Result	Reporting Limit	Qual	Units	BatchID	Dilution Factor	Date Analyzed	Analyst
<b>Trace Elements by ICP/MS E200.8</b>					<b>(E200.2)</b>			
Lead	BRL	1.00		ug/L	242777	1	05/17/2017 19:20	JR

**Qualifiers:**

- \* Value exceeds maximum contaminant level
- BRL Below reporting limit
- H Holding times for preparation or analysis exceeded
- N Analyte not NELAC certified
- B Analyte detected in the associated method blank
- > Greater than Result value

- E Estimated (value above quantitation range)
- S Spike Recovery outside limits due to matrix
- Narr See case narrative
- NC Not confirmed
- < Less than Result value
- J Estimated value detected below Reporting Limit

**Analytical Environmental Services, Inc**

**Date:** 19-May-17

<b>Client:</b> Atlanta Environmental Mgmt	<b>Client Sample ID:</b> 0193-050517-DF-010-A
<b>Project Name:</b> DCSD - 0193	<b>Collection Date:</b> 5/5/2017 6:23:00 AM
<b>Lab ID:</b> 1705525-020	<b>Matrix:</b> Drinking Water

Analyses	Result	Reporting Limit	Qual	Units	BatchID	Dilution Factor	Date Analyzed	Analyst
<b>Trace Elements by ICP/MS E200.8</b>					<b>(E200.2)</b>			
Lead	BRL	1.00		ug/L	242777	1	05/17/2017 19:24	JR

**Qualifiers:**

- \* Value exceeds maximum contaminant level
- BRL Below reporting limit
- H Holding times for preparation or analysis exceeded
- N Analyte not NELAC certified
- B Analyte detected in the associated method blank
- > Greater than Result value

- E Estimated (value above quantitation range)
- S Spike Recovery outside limits due to matrix
- Narr See case narrative
- NC Not confirmed
- < Less than Result value
- J Estimated value detected below Reporting Limit

**Analytical Environmental Services, Inc**

**Date:** 19-May-17

<b>Client:</b> Atlanta Environmental Mgmt	<b>Client Sample ID:</b> 0193-050517-DF-010-B
<b>Project Name:</b> DCSD - 0193	<b>Collection Date:</b> 5/5/2017 6:24:00 AM
<b>Lab ID:</b> 1705525-021	<b>Matrix:</b> Drinking Water

Analyses	Result	Reporting Limit	Qual	Units	BatchID	Dilution Factor	Date Analyzed	Analyst
<b>Trace Elements by ICP/MS E200.8</b>					<b>(E200.2)</b>			
Lead	BRL	1.00		ug/L	242778	1	05/17/2017 19:34	JR

**Qualifiers:**

- \* Value exceeds maximum contaminant level
- BRL Below reporting limit
- H Holding times for preparation or analysis exceeded
- N Analyte not NELAC certified
- B Analyte detected in the associated method blank
- > Greater than Result value

- E Estimated (value above quantitation range)
- S Spike Recovery outside limits due to matrix
- Narr See case narrative
- NC Not confirmed
- < Less than Result value
- J Estimated value detected below Reporting Limit

**Analytical Environmental Services, Inc**

**Date:** 19-May-17

<b>Client:</b> Atlanta Environmental Mgmt	<b>Client Sample ID:</b> 0193-050517-DF-011-A
<b>Project Name:</b> DCSD - 0193	<b>Collection Date:</b> 5/5/2017 6:17:00 AM
<b>Lab ID:</b> 1705525-022	<b>Matrix:</b> Drinking Water

Analyses	Result	Reporting Limit	Qual	Units	BatchID	Dilution Factor	Date Analyzed	Analyst
<b>Trace Elements by ICP/MS E200.8</b>					<b>(E200.2)</b>			
Lead	BRL	1.00		ug/L	242778	1	05/17/2017 19:59	JR

**Qualifiers:**

- \* Value exceeds maximum contaminant level
- BRL Below reporting limit
- H Holding times for preparation or analysis exceeded
- N Analyte not NELAC certified
- B Analyte detected in the associated method blank
- > Greater than Result value

- E Estimated (value above quantitation range)
- S Spike Recovery outside limits due to matrix
- Narr See case narrative
- NC Not confirmed
- < Less than Result value
- J Estimated value detected below Reporting Limit

**Analytical Environmental Services, Inc**

**Date:** 19-May-17

<b>Client:</b> Atlanta Environmental Mgmt	<b>Client Sample ID:</b> 0193-050517-DF-011-B
<b>Project Name:</b> DCSD - 0193	<b>Collection Date:</b> 5/5/2017 6:18:00 AM
<b>Lab ID:</b> 1705525-023	<b>Matrix:</b> Drinking Water

Analyses	Result	Reporting Limit	Qual	Units	BatchID	Dilution Factor	Date Analyzed	Analyst
<b>Trace Elements by ICP/MS E200.8</b>					<b>(E200.2)</b>			
Lead	BRL	1.00		ug/L	242778	1	05/17/2017 20:02	JR

**Qualifiers:**

- \* Value exceeds maximum contaminant level
- BRL Below reporting limit
- H Holding times for preparation or analysis exceeded
- N Analyte not NELAC certified
- B Analyte detected in the associated method blank
- > Greater than Result value

- E Estimated (value above quantitation range)
- S Spike Recovery outside limits due to matrix
- Narr See case narrative
- NC Not confirmed
- < Less than Result value
- J Estimated value detected below Reporting Limit

**Analytical Environmental Services, Inc**

**Date:** 19-May-17

<b>Client:</b> Atlanta Environmental Mgmt	<b>Client Sample ID:</b> 0193-050517-DF-012-A
<b>Project Name:</b> DCSD - 0193	<b>Collection Date:</b> 5/5/2017 6:15:00 AM
<b>Lab ID:</b> 1705525-024	<b>Matrix:</b> Drinking Water

Analyses	Result	Reporting Limit	Qual	Units	BatchID	Dilution Factor	Date Analyzed	Analyst
<b>Trace Elements by ICP/MS E200.8</b>					<b>(E200.2)</b>			
Lead	BRL	1.00		ug/L	242778	1	05/17/2017 20:06	JR

**Qualifiers:**

- \* Value exceeds maximum contaminant level
- BRL Below reporting limit
- H Holding times for preparation or analysis exceeded
- N Analyte not NELAC certified
- B Analyte detected in the associated method blank
- > Greater than Result value

- E Estimated (value above quantitation range)
- S Spike Recovery outside limits due to matrix
- Narr See case narrative
- NC Not confirmed
- < Less than Result value
- J Estimated value detected below Reporting Limit

**Analytical Environmental Services, Inc**

**Date:** 19-May-17

<b>Client:</b> Atlanta Environmental Mgmt	<b>Client Sample ID:</b> 0193-050517-DF-012-B
<b>Project Name:</b> DCSD - 0193	<b>Collection Date:</b> 5/5/2017 6:16:00 AM
<b>Lab ID:</b> 1705525-025	<b>Matrix:</b> Drinking Water

Analyses	Result	Reporting Limit	Qual	Units	BatchID	Dilution Factor	Date Analyzed	Analyst
<b>Trace Elements by ICP/MS E200.8</b>					<b>(E200.2)</b>			
Lead	BRL	1.00		ug/L	242778	1	05/17/2017 20:09	JR

**Qualifiers:**

- \* Value exceeds maximum contaminant level
- BRL Below reporting limit
- H Holding times for preparation or analysis exceeded
- N Analyte not NELAC certified
- B Analyte detected in the associated method blank
- > Greater than Result value

- E Estimated (value above quantitation range)
- S Spike Recovery outside limits due to matrix
- Narr See case narrative
- NC Not confirmed
- < Less than Result value
- J Estimated value detected below Reporting Limit

**Analytical Environmental Services, Inc**

**Date:** 19-May-17

<b>Client:</b> Atlanta Environmental Mgmt	<b>Client Sample ID:</b> 0193-050517-DF-013-A
<b>Project Name:</b> DCSD - 0193	<b>Collection Date:</b> 5/5/2017 6:12:00 AM
<b>Lab ID:</b> 1705525-026	<b>Matrix:</b> Drinking Water

Analyses	Result	Reporting Limit	Qual	Units	BatchID	Dilution Factor	Date Analyzed	Analyst
<b>Trace Elements by ICP/MS E200.8</b>					<b>(E200.2)</b>			
Lead	BRL	1.00		ug/L	242778	1	05/17/2017 20:13	JR

**Qualifiers:**

- \* Value exceeds maximum contaminant level
- BRL Below reporting limit
- H Holding times for preparation or analysis exceeded
- N Analyte not NELAC certified
- B Analyte detected in the associated method blank
- > Greater than Result value

- E Estimated (value above quantitation range)
- S Spike Recovery outside limits due to matrix
- Narr See case narrative
- NC Not confirmed
- < Less than Result value
- J Estimated value detected below Reporting Limit



**Analytical Environmental Services, Inc**

**Date:** 19-May-17

<b>Client:</b> Atlanta Environmental Mgmt	<b>Client Sample ID:</b> 0193-050517-DF-013-B
<b>Project Name:</b> DCSD - 0193	<b>Collection Date:</b> 5/5/2017 6:13:00 AM
<b>Lab ID:</b> 1705525-027	<b>Matrix:</b> Drinking Water

Analyses	Result	Reporting Limit	Qual	Units	BatchID	Dilution Factor	Date Analyzed	Analyst
<b>Trace Elements by ICP/MS E200.8</b>					<b>(E200.2)</b>			
Lead	BRL	1.00		ug/L	242778	1	05/17/2017 20:16	JR

**Qualifiers:**

- \* Value exceeds maximum contaminant level
- BRL Below reporting limit
- H Holding times for preparation or analysis exceeded
- N Analyte not NELAC certified
- B Analyte detected in the associated method blank
- > Greater than Result value

- E Estimated (value above quantitation range)
- S Spike Recovery outside limits due to matrix
- Narr See case narrative
- NC Not confirmed
- < Less than Result value
- J Estimated value detected below Reporting Limit

**Analytical Environmental Services, Inc**

**Date:** 19-May-17

<b>Client:</b> Atlanta Environmental Mgmt	<b>Client Sample ID:</b> 0193-050517-DF-014-A
<b>Project Name:</b> DCSD - 0193	<b>Collection Date:</b> 5/5/2017 6:10:00 AM
<b>Lab ID:</b> 1705525-028	<b>Matrix:</b> Drinking Water

Analyses	Result	Reporting Limit	Qual	Units	BatchID	Dilution Factor	Date Analyzed	Analyst
<b>Trace Elements by ICP/MS E200.8</b>					<b>(E200.2)</b>			
Lead	BRL	1.00		ug/L	242778	1	05/17/2017 20:20	JR

**Qualifiers:**

- \* Value exceeds maximum contaminant level
- BRL Below reporting limit
- H Holding times for preparation or analysis exceeded
- N Analyte not NELAC certified
- B Analyte detected in the associated method blank
- > Greater than Result value

- E Estimated (value above quantitation range)
- S Spike Recovery outside limits due to matrix
- Narr See case narrative
- NC Not confirmed
- < Less than Result value
- J Estimated value detected below Reporting Limit

**Analytical Environmental Services, Inc**

**Date:** 19-May-17

<b>Client:</b> Atlanta Environmental Mgmt	<b>Client Sample ID:</b> 0193-050517-DF-014-B
<b>Project Name:</b> DCSD - 0193	<b>Collection Date:</b> 5/5/2017 6:11:00 AM
<b>Lab ID:</b> 1705525-029	<b>Matrix:</b> Drinking Water

Analyses	Result	Reporting Limit	Qual	Units	BatchID	Dilution Factor	Date Analyzed	Analyst
<b>Trace Elements by ICP/MS E200.8</b>					<b>(E200.2)</b>			
Lead	BRL	1.00		ug/L	242778	1	05/17/2017 20:23	JR

**Qualifiers:**

- \* Value exceeds maximum contaminant level
- BRL Below reporting limit
- H Holding times for preparation or analysis exceeded
- N Analyte not NELAC certified
- B Analyte detected in the associated method blank
- > Greater than Result value

- E Estimated (value above quantitation range)
- S Spike Recovery outside limits due to matrix
- Narr See case narrative
- NC Not confirmed
- < Less than Result value
- J Estimated value detected below Reporting Limit

**Analytical Environmental Services, Inc**

**Date:** 19-May-17

<b>Client:</b> Atlanta Environmental Mgmt	<b>Client Sample ID:</b> 0193-050517-DF-015-A
<b>Project Name:</b> DCSD - 0193	<b>Collection Date:</b> 5/5/2017 6:06:00 AM
<b>Lab ID:</b> 1705525-030	<b>Matrix:</b> Drinking Water

Analyses	Result	Reporting Limit	Qual	Units	BatchID	Dilution Factor	Date Analyzed	Analyst
<b>Trace Elements by ICP/MS E200.8</b>					<b>(E200.2)</b>			
Lead	BRL	1.00		ug/L	242778	1	05/17/2017 20:34	JR

**Qualifiers:**

- \* Value exceeds maximum contaminant level
- BRL Below reporting limit
- H Holding times for preparation or analysis exceeded
- N Analyte not NELAC certified
- B Analyte detected in the associated method blank
- > Greater than Result value

- E Estimated (value above quantitation range)
- S Spike Recovery outside limits due to matrix
- Narr See case narrative
- NC Not confirmed
- < Less than Result value
- J Estimated value detected below Reporting Limit

**Analytical Environmental Services, Inc**

**Date:** 19-May-17

<b>Client:</b> Atlanta Environmental Mgmt	<b>Client Sample ID:</b> 0193-050517-DF-015-B
<b>Project Name:</b> DCSD - 0193	<b>Collection Date:</b> 5/5/2017 6:07:00 AM
<b>Lab ID:</b> 1705525-031	<b>Matrix:</b> Drinking Water

Analyses	Result	Reporting Limit	Qual	Units	BatchID	Dilution Factor	Date Analyzed	Analyst
<b>Trace Elements by ICP/MS E200.8</b>					<b>(E200.2)</b>			
Lead	BRL	1.00		ug/L	242778	1	05/17/2017 19:52	JR

**Qualifiers:**

- \* Value exceeds maximum contaminant level
- BRL Below reporting limit
- H Holding times for preparation or analysis exceeded
- N Analyte not NELAC certified
- B Analyte detected in the associated method blank
- > Greater than Result value

- E Estimated (value above quantitation range)
- S Spike Recovery outside limits due to matrix
- Narr See case narrative
- NC Not confirmed
- < Less than Result value
- J Estimated value detected below Reporting Limit

**Analytical Environmental Services, Inc**

**Date:** 19-May-17

<b>Client:</b> Atlanta Environmental Mgmt	<b>Client Sample ID:</b> 0193-050517-DF-016-A
<b>Project Name:</b> DCSD - 0193	<b>Collection Date:</b> 5/5/2017 6:04:00 AM
<b>Lab ID:</b> 1705525-032	<b>Matrix:</b> Drinking Water

Analyses	Result	Reporting Limit	Qual	Units	BatchID	Dilution Factor	Date Analyzed	Analyst
<b>Trace Elements by ICP/MS E200.8</b>					<b>(E200.2)</b>			
Lead	BRL	1.00		ug/L	242778	1	05/17/2017 20:37	JR

**Qualifiers:**

- \* Value exceeds maximum contaminant level
- BRL Below reporting limit
- H Holding times for preparation or analysis exceeded
- N Analyte not NELAC certified
- B Analyte detected in the associated method blank
- > Greater than Result value

- E Estimated (value above quantitation range)
- S Spike Recovery outside limits due to matrix
- Narr See case narrative
- NC Not confirmed
- < Less than Result value
- J Estimated value detected below Reporting Limit

**Analytical Environmental Services, Inc**

**Date:** 19-May-17

<b>Client:</b> Atlanta Environmental Mgmt	<b>Client Sample ID:</b> 0193-050517-DF-016-B
<b>Project Name:</b> DCSD - 0193	<b>Collection Date:</b> 5/5/2017 6:05:00 AM
<b>Lab ID:</b> 1705525-033	<b>Matrix:</b> Drinking Water

Analyses	Result	Reporting Limit	Qual	Units	BatchID	Dilution Factor	Date Analyzed	Analyst
<b>Trace Elements by ICP/MS E200.8</b>					<b>(E200.2)</b>			
Lead	BRL	1.00		ug/L	242778	1	05/17/2017 20:40	JR

**Qualifiers:**

- \* Value exceeds maximum contaminant level
- BRL Below reporting limit
- H Holding times for preparation or analysis exceeded
- N Analyte not NELAC certified
- B Analyte detected in the associated method blank
- > Greater than Result value

- E Estimated (value above quantitation range)
- S Spike Recovery outside limits due to matrix
- Narr See case narrative
- NC Not confirmed
- < Less than Result value
- J Estimated value detected below Reporting Limit

**Analytical Environmental Services, Inc**

**Date:** 19-May-17

<b>Client:</b> Atlanta Environmental Mgmt	<b>Client Sample ID:</b> 0193-050517-OT-001-A
<b>Project Name:</b> DCSD - 0193	<b>Collection Date:</b> 5/5/2017 5:57:00 AM
<b>Lab ID:</b> 1705525-034	<b>Matrix:</b> Drinking Water

Analyses	Result	Reporting Limit	Qual	Units	BatchID	Dilution Factor	Date Analyzed	Analyst
<b>Trace Elements by ICP/MS E200.8</b>					<b>(E200.2)</b>			
Lead	5.08	1.00		ug/L	242778	1	05/17/2017 20:44	JR

**Qualifiers:**

- \* Value exceeds maximum contaminant level
- BRL Below reporting limit
- H Holding times for preparation or analysis exceeded
- N Analyte not NELAC certified
- B Analyte detected in the associated method blank
- > Greater than Result value

- E Estimated (value above quantitation range)
- S Spike Recovery outside limits due to matrix
- Narr See case narrative
- NC Not confirmed
- < Less than Result value
- J Estimated value detected below Reporting Limit



**Analytical Environmental Services, Inc**

**Date:** 19-May-17

<b>Client:</b> Atlanta Environmental Mgmt	<b>Client Sample ID:</b> 0193-050517-OT-001-B
<b>Project Name:</b> DCSD - 0193	<b>Collection Date:</b> 5/5/2017 5:58:00 AM
<b>Lab ID:</b> 1705525-035	<b>Matrix:</b> Drinking Water

Analyses	Result	Reporting Limit	Qual	Units	BatchID	Dilution Factor	Date Analyzed	Analyst
<b>Trace Elements by ICP/MS E200.8</b>					<b>(E200.2)</b>			
Lead	BRL	1.00		ug/L	242778	1	05/17/2017 20:47	JR

**Qualifiers:**

- \* Value exceeds maximum contaminant level
- BRL Below reporting limit
- H Holding times for preparation or analysis exceeded
- N Analyte not NELAC certified
- B Analyte detected in the associated method blank
- > Greater than Result value

- E Estimated (value above quantitation range)
- S Spike Recovery outside limits due to matrix
- Narr See case narrative
- NC Not confirmed
- < Less than Result value
- J Estimated value detected below Reporting Limit

**Analytical Environmental Services, Inc**

**Date:** 19-May-17

<b>Client:</b> Atlanta Environmental Mgmt	<b>Client Sample ID:</b> 0193-050517-OT-002-A
<b>Project Name:</b> DCSD - 0193	<b>Collection Date:</b> 5/5/2017 6:14:00 AM
<b>Lab ID:</b> 1705525-036	<b>Matrix:</b> Drinking Water

Analyses	Result	Reporting Limit	Qual	Units	BatchID	Dilution Factor	Date Analyzed	Analyst
<b>Trace Elements by ICP/MS E200.8</b>					<b>(E200.2)</b>			
Lead	BRL	1.00		ug/L	242778	1	05/17/2017 20:51	JR

**Qualifiers:**

- \* Value exceeds maximum contaminant level
- BRL Below reporting limit
- H Holding times for preparation or analysis exceeded
- N Analyte not NELAC certified
- B Analyte detected in the associated method blank
- > Greater than Result value

- E Estimated (value above quantitation range)
- S Spike Recovery outside limits due to matrix
- Narr See case narrative
- NC Not confirmed
- < Less than Result value
- J Estimated value detected below Reporting Limit

**Analytical Environmental Services, Inc**

**Date:** 19-May-17

<b>Client:</b> Atlanta Environmental Mgmt	<b>Client Sample ID:</b> 0193-050517-OT-002-B
<b>Project Name:</b> DCSD - 0193	<b>Collection Date:</b> 5/5/2017 6:15:00 AM
<b>Lab ID:</b> 1705525-037	<b>Matrix:</b> Drinking Water

Analyses	Result	Reporting Limit	Qual	Units	BatchID	Dilution Factor	Date Analyzed	Analyst
<b>Trace Elements by ICP/MS E200.8</b>					<b>(E200.2)</b>			
Lead	BRL	1.00		ug/L	242778	1	05/17/2017 20:54	JR

**Qualifiers:**

- \* Value exceeds maximum contaminant level
- BRL Below reporting limit
- H Holding times for preparation or analysis exceeded
- N Analyte not NELAC certified
- B Analyte detected in the associated method blank
- > Greater than Result value

- E Estimated (value above quantitation range)
- S Spike Recovery outside limits due to matrix
- Narr See case narrative
- NC Not confirmed
- < Less than Result value
- J Estimated value detected below Reporting Limit

**Analytical Environmental Services, Inc**

**Date:** 19-May-17

<b>Client:</b> Atlanta Environmental Mgmt	<b>Client Sample ID:</b> 0193-050517-OT-003-A
<b>Project Name:</b> DCSD - 0193	<b>Collection Date:</b> 5/5/2017 6:00:00 AM
<b>Lab ID:</b> 1705525-038	<b>Matrix:</b> Drinking Water

Analyses	Result	Reporting Limit	Qual	Units	BatchID	Dilution Factor	Date Analyzed	Analyst
<b>Trace Elements by ICP/MS E200.8</b>					<b>(E200.2)</b>			
Lead	2.93	1.00		ug/L	242778	1	05/19/2017 00:14	JR

**Qualifiers:**

- \* Value exceeds maximum contaminant level
- BRL Below reporting limit
- H Holding times for preparation or analysis exceeded
- N Analyte not NELAC certified
- B Analyte detected in the associated method blank
- > Greater than Result value

- E Estimated (value above quantitation range)
- S Spike Recovery outside limits due to matrix
- Narr See case narrative
- NC Not confirmed
- < Less than Result value
- J Estimated value detected below Reporting Limit

**Analytical Environmental Services, Inc**

**Date:** 19-May-17

<b>Client:</b> Atlanta Environmental Mgmt	<b>Client Sample ID:</b> 0193-050517-OT-003-B
<b>Project Name:</b> DCSD - 0193	<b>Collection Date:</b> 5/5/2017 6:01:00 AM
<b>Lab ID:</b> 1705525-039	<b>Matrix:</b> Drinking Water

Analyses	Result	Reporting Limit	Qual	Units	BatchID	Dilution Factor	Date Analyzed	Analyst
<b>Trace Elements by ICP/MS E200.8</b>					<b>(E200.2)</b>			
Lead	BRL	1.00		ug/L	242778	1	05/17/2017 21:01	JR

**Qualifiers:**

- \* Value exceeds maximum contaminant level
- BRL Below reporting limit
- H Holding times for preparation or analysis exceeded
- N Analyte not NELAC certified
- B Analyte detected in the associated method blank
- > Greater than Result value

- E Estimated (value above quantitation range)
- S Spike Recovery outside limits due to matrix
- Narr See case narrative
- NC Not confirmed
- < Less than Result value
- J Estimated value detected below Reporting Limit

**Analytical Environmental Services, Inc**

**Date:** 19-May-17

<b>Client:</b> Atlanta Environmental Mgmt	<b>Client Sample ID:</b> 0193-050517-OT-004-A
<b>Project Name:</b> DCSD - 0193	<b>Collection Date:</b> 5/5/2017 5:50:00 AM
<b>Lab ID:</b> 1705525-040	<b>Matrix:</b> Drinking Water

Analyses	Result	Reporting Limit	Qual	Units	BatchID	Dilution Factor	Date Analyzed	Analyst
<b>Trace Elements by ICP/MS E200.8</b>					<b>(E200.2)</b>			
Lead	BRL	1.00		ug/L	242778	1	05/17/2017 21:05	JR

**Qualifiers:**

- \* Value exceeds maximum contaminant level
- BRL Below reporting limit
- H Holding times for preparation or analysis exceeded
- N Analyte not NELAC certified
- B Analyte detected in the associated method blank
- > Greater than Result value

- E Estimated (value above quantitation range)
- S Spike Recovery outside limits due to matrix
- Narr See case narrative
- NC Not confirmed
- < Less than Result value
- J Estimated value detected below Reporting Limit

**Analytical Environmental Services, Inc**

**Date:** 19-May-17

<b>Client:</b> Atlanta Environmental Mgmt	<b>Client Sample ID:</b> 0193-050517-OT-004-B
<b>Project Name:</b> DCSD - 0193	<b>Collection Date:</b> 5/5/2017 5:51:00 AM
<b>Lab ID:</b> 1705525-041	<b>Matrix:</b> Drinking Water

Analyses	Result	Reporting Limit	Qual	Units	BatchID	Dilution Factor	Date Analyzed	Analyst
<b>Trace Elements by ICP/MS E200.8</b>					<b>(E200.2)</b>			
Lead	BRL	1.00		ug/L	242779	1	05/17/2017 21:22	JR

**Qualifiers:**

- \* Value exceeds maximum contaminant level
- BRL Below reporting limit
- H Holding times for preparation or analysis exceeded
- N Analyte not NELAC certified
- B Analyte detected in the associated method blank
- > Greater than Result value

- E Estimated (value above quantitation range)
- S Spike Recovery outside limits due to matrix
- Narr See case narrative
- NC Not confirmed
- < Less than Result value
- J Estimated value detected below Reporting Limit

**Analytical Environmental Services, Inc**

**Date:** 19-May-17

<b>Client:</b> Atlanta Environmental Mgmt	<b>Client Sample ID:</b> 0193-050517-RS-001-A
<b>Project Name:</b> DCSD - 0193	<b>Collection Date:</b> 5/5/2017 5:52:00 AM
<b>Lab ID:</b> 1705525-042	<b>Matrix:</b> Drinking Water

Analyses	Result	Reporting Limit	Qual	Units	BatchID	Dilution Factor	Date Analyzed	Analyst
<b>Trace Elements by ICP/MS E200.8</b>					<b>(E200.2)</b>			
Lead	BRL	1.00		ug/L	242779	1	05/17/2017 21:40	JR

**Qualifiers:**

- \* Value exceeds maximum contaminant level
- BRL Below reporting limit
- H Holding times for preparation or analysis exceeded
- N Analyte not NELAC certified
- B Analyte detected in the associated method blank
- > Greater than Result value

- E Estimated (value above quantitation range)
- S Spike Recovery outside limits due to matrix
- Narr See case narrative
- NC Not confirmed
- < Less than Result value
- J Estimated value detected below Reporting Limit



**Analytical Environmental Services, Inc**

**Date:** 19-May-17

<b>Client:</b> Atlanta Environmental Mgmt	<b>Client Sample ID:</b> 0193-050517-RS-001-B
<b>Project Name:</b> DCSD - 0193	<b>Collection Date:</b> 5/5/2017 5:54:00 AM
<b>Lab ID:</b> 1705525-043	<b>Matrix:</b> Drinking Water

Analyses	Result	Reporting Limit	Qual	Units	BatchID	Dilution Factor	Date Analyzed	Analyst
<b>Trace Elements by ICP/MS E200.8</b>					<b>(E200.2)</b>			
Lead	BRL	1.00		ug/L	242779	1	05/17/2017 21:43	JR

**Qualifiers:**

- \* Value exceeds maximum contaminant level
- BRL Below reporting limit
- H Holding times for preparation or analysis exceeded
- N Analyte not NELAC certified
- B Analyte detected in the associated method blank
- > Greater than Result value

- E Estimated (value above quantitation range)
- S Spike Recovery outside limits due to matrix
- Narr See case narrative
- NC Not confirmed
- < Less than Result value
- J Estimated value detected below Reporting Limit

**Analytical Environmental Services, Inc**

**Date:** 19-May-17

<b>Client:</b> Atlanta Environmental Mgmt	<b>Client Sample ID:</b> 0193-050517-RS-001-C
<b>Project Name:</b> DCSD - 0193	<b>Collection Date:</b> 5/5/2017 5:53:00 AM
<b>Lab ID:</b> 1705525-044	<b>Matrix:</b> Drinking Water

Analyses	Result	Reporting Limit	Qual	Units	BatchID	Dilution Factor	Date Analyzed	Analyst
<b>Trace Elements by ICP/MS E200.8</b>					<b>(E200.2)</b>			
Lead	BRL	1.00		ug/L	242779	1	05/17/2017 21:47	JR

**Qualifiers:**

- \* Value exceeds maximum contaminant level
- BRL Below reporting limit
- H Holding times for preparation or analysis exceeded
- N Analyte not NELAC certified
- B Analyte detected in the associated method blank
- > Greater than Result value

- E Estimated (value above quantitation range)
- S Spike Recovery outside limits due to matrix
- Narr See case narrative
- NC Not confirmed
- < Less than Result value
- J Estimated value detected below Reporting Limit

**Analytical Environmental Services, Inc**

**Date:** 19-May-17

<b>Client:</b> Atlanta Environmental Mgmt	<b>Client Sample ID:</b> 0193-050517-RS-002-A
<b>Project Name:</b> DCSD - 0193	<b>Collection Date:</b> 5/5/2017 5:44:00 AM
<b>Lab ID:</b> 1705525-045	<b>Matrix:</b> Drinking Water

Analyses	Result	Reporting Limit	Qual	Units	BatchID	Dilution Factor	Date Analyzed	Analyst
<b>Trace Elements by ICP/MS E200.8</b>					<b>(E200.2)</b>			
Lead	BRL	1.00		ug/L	242779	1	05/17/2017 21:57	JR

**Qualifiers:**

- \* Value exceeds maximum contaminant level
- BRL Below reporting limit
- H Holding times for preparation or analysis exceeded
- N Analyte not NELAC certified
- B Analyte detected in the associated method blank
- > Greater than Result value

- E Estimated (value above quantitation range)
- S Spike Recovery outside limits due to matrix
- Narr See case narrative
- NC Not confirmed
- < Less than Result value
- J Estimated value detected below Reporting Limit

**Analytical Environmental Services, Inc**

**Date:** 19-May-17

<b>Client:</b> Atlanta Environmental Mgmt	<b>Client Sample ID:</b> 0193-050517-RS-002-B
<b>Project Name:</b> DCSD - 0193	<b>Collection Date:</b> 5/5/2017 5:45:00 AM
<b>Lab ID:</b> 1705525-046	<b>Matrix:</b> Drinking Water

Analyses	Result	Reporting Limit	Qual	Units	BatchID	Dilution Factor	Date Analyzed	Analyst
<b>Trace Elements by ICP/MS E200.8</b>					<b>(E200.2)</b>			
Lead	BRL	1.00		ug/L	242779	1	05/17/2017 22:01	JR

**Qualifiers:**

- \* Value exceeds maximum contaminant level
- BRL Below reporting limit
- H Holding times for preparation or analysis exceeded
- N Analyte not NELAC certified
- B Analyte detected in the associated method blank
- > Greater than Result value

- E Estimated (value above quantitation range)
- S Spike Recovery outside limits due to matrix
- Narr See case narrative
- NC Not confirmed
- < Less than Result value
- J Estimated value detected below Reporting Limit

**Analytical Environmental Services, Inc**

**Date:** 19-May-17

<b>Client:</b> Atlanta Environmental Mgmt	<b>Client Sample ID:</b> 0193-050517-CS-001-A
<b>Project Name:</b> DCSD - 0193	<b>Collection Date:</b> 5/5/2017 5:08:00 AM
<b>Lab ID:</b> 1705525-047	<b>Matrix:</b> Drinking Water

Analyses	Result	Reporting Limit	Qual	Units	BatchID	Dilution Factor	Date Analyzed	Analyst
<b>Trace Elements by ICP/MS E200.8</b>					<b>(E200.2)</b>			
Lead	BRL	1.00		ug/L	242779	1	05/17/2017 22:04	JR

**Qualifiers:**

- \* Value exceeds maximum contaminant level
- BRL Below reporting limit
- H Holding times for preparation or analysis exceeded
- N Analyte not NELAC certified
- B Analyte detected in the associated method blank
- > Greater than Result value

- E Estimated (value above quantitation range)
- S Spike Recovery outside limits due to matrix
- Narr See case narrative
- NC Not confirmed
- < Less than Result value
- J Estimated value detected below Reporting Limit

**Analytical Environmental Services, Inc**

**Date:** 19-May-17

<b>Client:</b> Atlanta Environmental Mgmt	<b>Client Sample ID:</b> 0193-050517-CS-001-B
<b>Project Name:</b> DCSD - 0193	<b>Collection Date:</b> 5/5/2017 5:09:00 AM
<b>Lab ID:</b> 1705525-048	<b>Matrix:</b> Drinking Water

Analyses	Result	Reporting Limit	Qual	Units	BatchID	Dilution Factor	Date Analyzed	Analyst
<b>Trace Elements by ICP/MS E200.8</b>					<b>(E200.2)</b>			
Lead	BRL	1.00		ug/L	242779	1	05/17/2017 22:07	JR

**Qualifiers:**

- \* Value exceeds maximum contaminant level
- BRL Below reporting limit
- H Holding times for preparation or analysis exceeded
- N Analyte not NELAC certified
- B Analyte detected in the associated method blank
- > Greater than Result value

- E Estimated (value above quantitation range)
- S Spike Recovery outside limits due to matrix
- Narr See case narrative
- NC Not confirmed
- < Less than Result value
- J Estimated value detected below Reporting Limit

**Analytical Environmental Services, Inc**

**Date:** 19-May-17

<b>Client:</b> Atlanta Environmental Mgmt	<b>Client Sample ID:</b> 0193-050517-CS-002-A
<b>Project Name:</b> DCSD - 0193	<b>Collection Date:</b> 5/5/2017 5:18:00 AM
<b>Lab ID:</b> 1705525-049	<b>Matrix:</b> Drinking Water

Analyses	Result	Reporting Limit	Qual	Units	BatchID	Dilution Factor	Date Analyzed	Analyst
<b>Trace Elements by ICP/MS E200.8</b>					<b>(E200.2)</b>			
Lead	3.28	1.00		ug/L	242779	1	05/19/2017 00:33	JR

**Qualifiers:**

- \* Value exceeds maximum contaminant level
- BRL Below reporting limit
- H Holding times for preparation or analysis exceeded
- N Analyte not NELAC certified
- B Analyte detected in the associated method blank
- > Greater than Result value

- E Estimated (value above quantitation range)
- S Spike Recovery outside limits due to matrix
- Narr See case narrative
- NC Not confirmed
- < Less than Result value
- J Estimated value detected below Reporting Limit

**Analytical Environmental Services, Inc**

**Date:** 19-May-17

<b>Client:</b> Atlanta Environmental Mgmt	<b>Client Sample ID:</b> 0193-050517-CS-002-B
<b>Project Name:</b> DCSD - 0193	<b>Collection Date:</b> 5/5/2017 5:19:00 AM
<b>Lab ID:</b> 1705525-050	<b>Matrix:</b> Drinking Water

Analyses	Result	Reporting Limit	Qual	Units	BatchID	Dilution Factor	Date Analyzed	Analyst
<b>Trace Elements by ICP/MS E200.8</b>					<b>(E200.2)</b>			
Lead	BRL	1.00		ug/L	242779	1	05/17/2017 22:14	JR

**Qualifiers:**

- \* Value exceeds maximum contaminant level
- BRL Below reporting limit
- H Holding times for preparation or analysis exceeded
- N Analyte not NELAC certified
- B Analyte detected in the associated method blank
- > Greater than Result value

- E Estimated (value above quantitation range)
- S Spike Recovery outside limits due to matrix
- Narr See case narrative
- NC Not confirmed
- < Less than Result value
- J Estimated value detected below Reporting Limit



**Analytical Environmental Services, Inc**

**Date:** 19-May-17

<b>Client:</b> Atlanta Environmental Mgmt	<b>Client Sample ID:</b> 0193-050517-CS-003-A
<b>Project Name:</b> DCSD - 0193	<b>Collection Date:</b> 5/5/2017 5:20:00 AM
<b>Lab ID:</b> 1705525-051	<b>Matrix:</b> Drinking Water

Analyses	Result	Reporting Limit	Qual	Units	BatchID	Dilution Factor	Date Analyzed	Analyst
<b>Trace Elements by ICP/MS E200.8</b>					<b>(E200.2)</b>			
Lead	2.36	1.00		ug/L	242779	1	05/19/2017 00:26	JR

**Qualifiers:**

- \* Value exceeds maximum contaminant level
- BRL Below reporting limit
- H Holding times for preparation or analysis exceeded
- N Analyte not NELAC certified
- B Analyte detected in the associated method blank
- > Greater than Result value

- E Estimated (value above quantitation range)
- S Spike Recovery outside limits due to matrix
- Narr See case narrative
- NC Not confirmed
- < Less than Result value
- J Estimated value detected below Reporting Limit

**Analytical Environmental Services, Inc**

**Date:** 19-May-17

<b>Client:</b> Atlanta Environmental Mgmt	<b>Client Sample ID:</b> 0193-050517-CS-003-B
<b>Project Name:</b> DCSD - 0193	<b>Collection Date:</b> 5/5/2017 5:21:00 AM
<b>Lab ID:</b> 1705525-052	<b>Matrix:</b> Drinking Water

Analyses	Result	Reporting Limit	Qual	Units	BatchID	Dilution Factor	Date Analyzed	Analyst
<b>Trace Elements by ICP/MS E200.8</b>					<b>(E200.2)</b>			
Lead	BRL	1.00		ug/L	242779	1	05/17/2017 22:18	JR

**Qualifiers:**

- \* Value exceeds maximum contaminant level
- BRL Below reporting limit
- H Holding times for preparation or analysis exceeded
- N Analyte not NELAC certified
- B Analyte detected in the associated method blank
- > Greater than Result value

- E Estimated (value above quantitation range)
- S Spike Recovery outside limits due to matrix
- Narr See case narrative
- NC Not confirmed
- < Less than Result value
- J Estimated value detected below Reporting Limit

**Analytical Environmental Services, Inc**

**Date:** 19-May-17

<b>Client:</b> Atlanta Environmental Mgmt	<b>Client Sample ID:</b> 0193-050517-CS-004-A
<b>Project Name:</b> DCSD - 0193	<b>Collection Date:</b> 5/5/2017 5:22:00 AM
<b>Lab ID:</b> 1705525-053	<b>Matrix:</b> Drinking Water

Analyses	Result	Reporting Limit	Qual	Units	BatchID	Dilution Factor	Date Analyzed	Analyst
<b>Trace Elements by ICP/MS E200.8</b>					<b>(E200.2)</b>			
Lead	4.08	1.00		ug/L	242779	1	05/19/2017 00:39	JR

**Qualifiers:**

- \* Value exceeds maximum contaminant level
- BRL Below reporting limit
- H Holding times for preparation or analysis exceeded
- N Analyte not NELAC certified
- B Analyte detected in the associated method blank
- > Greater than Result value

- E Estimated (value above quantitation range)
- S Spike Recovery outside limits due to matrix
- Narr See case narrative
- NC Not confirmed
- < Less than Result value
- J Estimated value detected below Reporting Limit

**Analytical Environmental Services, Inc**

**Date:** 19-May-17

<b>Client:</b> Atlanta Environmental Mgmt	<b>Client Sample ID:</b> 0193-050517-CS-004-B
<b>Project Name:</b> DCSD - 0193	<b>Collection Date:</b> 5/5/2017 5:23:00 AM
<b>Lab ID:</b> 1705525-054	<b>Matrix:</b> Drinking Water

Analyses	Result	Reporting Limit	Qual	Units	BatchID	Dilution Factor	Date Analyzed	Analyst
<b>Trace Elements by ICP/MS E200.8</b>					<b>(E200.2)</b>			
Lead	BRL	1.00		ug/L	242779	1	05/17/2017 22:25	JR

**Qualifiers:**

- \* Value exceeds maximum contaminant level
- BRL Below reporting limit
- H Holding times for preparation or analysis exceeded
- N Analyte not NELAC certified
- B Analyte detected in the associated method blank
- > Greater than Result value

- E Estimated (value above quantitation range)
- S Spike Recovery outside limits due to matrix
- Narr See case narrative
- NC Not confirmed
- < Less than Result value
- J Estimated value detected below Reporting Limit

**Analytical Environmental Services, Inc**

**Date:** 19-May-17

<b>Client:</b> Atlanta Environmental Mgmt	<b>Client Sample ID:</b> 0193-050517-CS-005-A
<b>Project Name:</b> DCSD - 0193	<b>Collection Date:</b> 5/5/2017 5:24:00 AM
<b>Lab ID:</b> 1705525-055	<b>Matrix:</b> Drinking Water

Analyses	Result	Reporting Limit	Qual	Units	BatchID	Dilution Factor	Date Analyzed	Analyst
<b>Trace Elements by ICP/MS E200.8</b>					<b>(E200.2)</b>			
Lead	6.34	1.00		ug/L	242779	1	05/19/2017 00:45	JR

**Qualifiers:**

- \* Value exceeds maximum contaminant level
- BRL Below reporting limit
- H Holding times for preparation or analysis exceeded
- N Analyte not NELAC certified
- B Analyte detected in the associated method blank
- > Greater than Result value

- E Estimated (value above quantitation range)
- S Spike Recovery outside limits due to matrix
- Narr See case narrative
- NC Not confirmed
- < Less than Result value
- J Estimated value detected below Reporting Limit

**Analytical Environmental Services, Inc**

**Date:** 19-May-17

<b>Client:</b> Atlanta Environmental Mgmt	<b>Client Sample ID:</b> 0193-050517-CS-005-B
<b>Project Name:</b> DCSD - 0193	<b>Collection Date:</b> 5/5/2017 5:25:00 AM
<b>Lab ID:</b> 1705525-056	<b>Matrix:</b> Drinking Water

Analyses	Result	Reporting Limit	Qual	Units	BatchID	Dilution Factor	Date Analyzed	Analyst
<b>Trace Elements by ICP/MS E200.8</b>					<b>(E200.2)</b>			
Lead	BRL	1.00		ug/L	242779	1	05/17/2017 22:39	JR

**Qualifiers:**

- \* Value exceeds maximum contaminant level
- BRL Below reporting limit
- H Holding times for preparation or analysis exceeded
- N Analyte not NELAC certified
- B Analyte detected in the associated method blank
- > Greater than Result value

- E Estimated (value above quantitation range)
- S Spike Recovery outside limits due to matrix
- Narr See case narrative
- NC Not confirmed
- < Less than Result value
- J Estimated value detected below Reporting Limit

**Analytical Environmental Services, Inc**

**Date:** 19-May-17

<b>Client:</b> Atlanta Environmental Mgmt	<b>Client Sample ID:</b> 0193-050517-CS-006-A
<b>Project Name:</b> DCSD - 0193	<b>Collection Date:</b> 5/5/2017 5:26:00 AM
<b>Lab ID:</b> 1705525-057	<b>Matrix:</b> Drinking Water

Analyses	Result	Reporting Limit	Qual	Units	BatchID	Dilution Factor	Date Analyzed	Analyst
<b>Trace Elements by ICP/MS E200.8</b>					<b>(E200.2)</b>			
Lead	1.52	1.00		ug/L	242779	1	05/17/2017 22:42	JR

**Qualifiers:**

- \* Value exceeds maximum contaminant level
- BRL Below reporting limit
- H Holding times for preparation or analysis exceeded
- N Analyte not NELAC certified
- B Analyte detected in the associated method blank
- > Greater than Result value

- E Estimated (value above quantitation range)
- S Spike Recovery outside limits due to matrix
- Narr See case narrative
- NC Not confirmed
- < Less than Result value
- J Estimated value detected below Reporting Limit

**Analytical Environmental Services, Inc**

**Date:** 19-May-17

<b>Client:</b> Atlanta Environmental Mgmt	<b>Client Sample ID:</b> 0193-050517-CS-006-B
<b>Project Name:</b> DCSD - 0193	<b>Collection Date:</b> 5/5/2017 5:27:00 AM
<b>Lab ID:</b> 1705525-058	<b>Matrix:</b> Drinking Water

Analyses	Result	Reporting Limit	Qual	Units	BatchID	Dilution Factor	Date Analyzed	Analyst
<b>Trace Elements by ICP/MS E200.8</b>					<b>(E200.2)</b>			
Lead	BRL	1.00		ug/L	242779	1	05/17/2017 22:46	JR

**Qualifiers:**

- \* Value exceeds maximum contaminant level
- BRL Below reporting limit
- H Holding times for preparation or analysis exceeded
- N Analyte not NELAC certified
- B Analyte detected in the associated method blank
- > Greater than Result value

- E Estimated (value above quantitation range)
- S Spike Recovery outside limits due to matrix
- Narr See case narrative
- NC Not confirmed
- < Less than Result value
- J Estimated value detected below Reporting Limit



**Analytical Environmental Services, Inc**

**Date:** 19-May-17

<b>Client:</b> Atlanta Environmental Mgmt	<b>Client Sample ID:</b> 0193-050517-CS-007-A
<b>Project Name:</b> DCSD - 0193	<b>Collection Date:</b> 5/5/2017 5:28:00 AM
<b>Lab ID:</b> 1705525-059	<b>Matrix:</b> Drinking Water

Analyses	Result	Reporting Limit	Qual	Units	BatchID	Dilution Factor	Date Analyzed	Analyst
<b>Trace Elements by ICP/MS E200.8</b>					<b>(E200.2)</b>			
Lead	4.97	1.00		ug/L	242779	1	05/17/2017 22:49	JR

**Qualifiers:**

- \* Value exceeds maximum contaminant level
- BRL Below reporting limit
- H Holding times for preparation or analysis exceeded
- N Analyte not NELAC certified
- B Analyte detected in the associated method blank
- > Greater than Result value

- E Estimated (value above quantitation range)
- S Spike Recovery outside limits due to matrix
- Narr See case narrative
- NC Not confirmed
- < Less than Result value
- J Estimated value detected below Reporting Limit

**Analytical Environmental Services, Inc**

**Date:** 19-May-17

<b>Client:</b> Atlanta Environmental Mgmt	<b>Client Sample ID:</b> 0193-050517-CS-007-B
<b>Project Name:</b> DCSD - 0193	<b>Collection Date:</b> 5/5/2017 5:29:00 AM
<b>Lab ID:</b> 1705525-060	<b>Matrix:</b> Drinking Water

Analyses	Result	Reporting Limit	Qual	Units	BatchID	Dilution Factor	Date Analyzed	Analyst
<b>Trace Elements by ICP/MS E200.8</b>					<b>(E200.2)</b>			
Lead	BRL	1.00		ug/L	242779	1	05/17/2017 22:53	JR

**Qualifiers:**

- \* Value exceeds maximum contaminant level
- BRL Below reporting limit
- H Holding times for preparation or analysis exceeded
- N Analyte not NELAC certified
- B Analyte detected in the associated method blank
- > Greater than Result value

- E Estimated (value above quantitation range)
- S Spike Recovery outside limits due to matrix
- Narr See case narrative
- NC Not confirmed
- < Less than Result value
- J Estimated value detected below Reporting Limit

**Analytical Environmental Services, Inc**

**Date:** 19-May-17

<b>Client:</b> Atlanta Environmental Mgmt	<b>Client Sample ID:</b> 0193-050517-TL-001-A
<b>Project Name:</b> DCSD - 0193	<b>Collection Date:</b> 5/5/2017 5:40:00 AM
<b>Lab ID:</b> 1705525-061	<b>Matrix:</b> Drinking Water

Analyses	Result	Reporting Limit	Qual	Units	BatchID	Dilution Factor	Date Analyzed	Analyst
<b>Trace Elements by ICP/MS E200.8</b>					<b>(E200.2)</b>			
Lead	BRL	1.00		ug/L	242782	1	05/18/2017 02:12	JR

**Qualifiers:**

- \* Value exceeds maximum contaminant level
- BRL Below reporting limit
- H Holding times for preparation or analysis exceeded
- N Analyte not NELAC certified
- B Analyte detected in the associated method blank
- > Greater than Result value

- E Estimated (value above quantitation range)
- S Spike Recovery outside limits due to matrix
- Narr See case narrative
- NC Not confirmed
- < Less than Result value
- J Estimated value detected below Reporting Limit

**Analytical Environmental Services, Inc**

**Date:** 19-May-17

<b>Client:</b> Atlanta Environmental Mgmt	<b>Client Sample ID:</b> 0193-050517-TL-001-B
<b>Project Name:</b> DCSD - 0193	<b>Collection Date:</b> 5/5/2017 5:41:00 AM
<b>Lab ID:</b> 1705525-062	<b>Matrix:</b> Drinking Water

Analyses	Result	Reporting Limit	Qual	Units	BatchID	Dilution Factor	Date Analyzed	Analyst
<b>Trace Elements by ICP/MS E200.8</b>					<b>(E200.2)</b>			
Lead	BRL	1.00		ug/L	242782	1	05/18/2017 02:15	JR

**Qualifiers:**

- \* Value exceeds maximum contaminant level
- BRL Below reporting limit
- H Holding times for preparation or analysis exceeded
- N Analyte not NELAC certified
- B Analyte detected in the associated method blank
- > Greater than Result value

- E Estimated (value above quantitation range)
- S Spike Recovery outside limits due to matrix
- Narr See case narrative
- NC Not confirmed
- < Less than Result value
- J Estimated value detected below Reporting Limit

**Analytical Environmental Services, Inc**

**Date:** 19-May-17

<b>Client:</b> Atlanta Environmental Mgmt	<b>Client Sample ID:</b> 0193-050517-TL-002-A
<b>Project Name:</b> DCSD - 0193	<b>Collection Date:</b> 5/5/2017 6:04:00 AM
<b>Lab ID:</b> 1705525-063	<b>Matrix:</b> Drinking Water

Analyses	Result	Reporting Limit	Qual	Units	BatchID	Dilution Factor	Date Analyzed	Analyst
<b>Trace Elements by ICP/MS E200.8</b>					<b>(E200.2)</b>			
Lead	39.3	1.00		ug/L	242782	1	05/18/2017 02:19	JR

**Qualifiers:**

- \* Value exceeds maximum contaminant level
- BRL Below reporting limit
- H Holding times for preparation or analysis exceeded
- N Analyte not NELAC certified
- B Analyte detected in the associated method blank
- > Greater than Result value

- E Estimated (value above quantitation range)
- S Spike Recovery outside limits due to matrix
- Narr See case narrative
- NC Not confirmed
- < Less than Result value
- J Estimated value detected below Reporting Limit

**Analytical Environmental Services, Inc**

**Date:** 19-May-17

<b>Client:</b> Atlanta Environmental Mgmt	<b>Client Sample ID:</b> 0193-050517-TL-002-B
<b>Project Name:</b> DCSD - 0193	<b>Collection Date:</b> 5/5/2017 6:05:00 AM
<b>Lab ID:</b> 1705525-064	<b>Matrix:</b> Drinking Water

Analyses	Result	Reporting Limit	Qual	Units	BatchID	Dilution Factor	Date Analyzed	Analyst
<b>Trace Elements by ICP/MS E200.8</b>					<b>(E200.2)</b>			
Lead	1.42	1.00		ug/L	242782	1	05/18/2017 02:22	JR

**Qualifiers:**

- \* Value exceeds maximum contaminant level
- BRL Below reporting limit
- H Holding times for preparation or analysis exceeded
- N Analyte not NELAC certified
- B Analyte detected in the associated method blank
- > Greater than Result value

- E Estimated (value above quantitation range)
- S Spike Recovery outside limits due to matrix
- Narr See case narrative
- NC Not confirmed
- < Less than Result value
- J Estimated value detected below Reporting Limit

**Analytical Environmental Services, Inc**

**Date:** 19-May-17

<b>Client:</b> Atlanta Environmental Mgmt	<b>Client Sample ID:</b> 0193-050517-TL-003-A
<b>Project Name:</b> DCSD - 0193	<b>Collection Date:</b> 5/5/2017 6:09:00 AM
<b>Lab ID:</b> 1705525-065	<b>Matrix:</b> Drinking Water

Analyses	Result	Reporting Limit	Qual	Units	BatchID	Dilution Factor	Date Analyzed	Analyst
<b>Trace Elements by ICP/MS E200.8</b>					<b>(E200.2)</b>			
Lead	BRL	1.00		ug/L	242782	1	05/18/2017 02:26	JR

**Qualifiers:**

- \* Value exceeds maximum contaminant level
- BRL Below reporting limit
- H Holding times for preparation or analysis exceeded
- N Analyte not NELAC certified
- B Analyte detected in the associated method blank
- > Greater than Result value

- E Estimated (value above quantitation range)
- S Spike Recovery outside limits due to matrix
- Narr See case narrative
- NC Not confirmed
- < Less than Result value
- J Estimated value detected below Reporting Limit

**Analytical Environmental Services, Inc**

**Date:** 19-May-17

<b>Client:</b> Atlanta Environmental Mgmt	<b>Client Sample ID:</b> 0193-050517-TL-003-B
<b>Project Name:</b> DCSD - 0193	<b>Collection Date:</b> 5/5/2017 6:10:00 AM
<b>Lab ID:</b> 1705525-066	<b>Matrix:</b> Drinking Water

Analyses	Result	Reporting Limit	Qual	Units	BatchID	Dilution Factor	Date Analyzed	Analyst
<b>Trace Elements by ICP/MS E200.8</b>					<b>(E200.2)</b>			
Lead	BRL	1.00		ug/L	242782	1	05/18/2017 01:47	JR

**Qualifiers:**

- \* Value exceeds maximum contaminant level
- BRL Below reporting limit
- H Holding times for preparation or analysis exceeded
- N Analyte not NELAC certified
- B Analyte detected in the associated method blank
- > Greater than Result value

- E Estimated (value above quantitation range)
- S Spike Recovery outside limits due to matrix
- Narr See case narrative
- NC Not confirmed
- < Less than Result value
- J Estimated value detected below Reporting Limit



**Analytical Environmental Services, Inc**

**Date:** 19-May-17

<b>Client:</b> Atlanta Environmental Mgmt	<b>Client Sample ID:</b> 0193-050517-IM-001-A
<b>Project Name:</b> DCSD - 0193	<b>Collection Date:</b> 5/5/2017 5:02:00 AM
<b>Lab ID:</b> 1705525-067	<b>Matrix:</b> Drinking Water

Analyses	Result	Reporting Limit	Qual	Units	BatchID	Dilution Factor	Date Analyzed	Analyst
<b>Trace Elements by ICP/MS E200.8</b>					<b>(E200.2)</b>			
Lead	BRL	1.00		ug/L	242782	1	05/18/2017 02:29	JR

**Qualifiers:**

- \* Value exceeds maximum contaminant level
- BRL Below reporting limit
- H Holding times for preparation or analysis exceeded
- N Analyte not NELAC certified
- B Analyte detected in the associated method blank
- > Greater than Result value

- E Estimated (value above quantitation range)
- S Spike Recovery outside limits due to matrix
- Narr See case narrative
- NC Not confirmed
- < Less than Result value
- J Estimated value detected below Reporting Limit

**Analytical Environmental Services, Inc**

**Date:** 19-May-17

<b>Client:</b> Atlanta Environmental Mgmt	<b>Client Sample ID:</b> 0193-050517-SC-001-A
<b>Project Name:</b> DCSD - 0193	<b>Collection Date:</b> 5/5/2017 4:53:00 AM
<b>Lab ID:</b> 1705525-068	<b>Matrix:</b> Drinking Water

Analyses	Result	Reporting Limit	Qual	Units	BatchID	Dilution Factor	Date Analyzed	Analyst
<b>Trace Elements by ICP/MS E200.8</b>					<b>(E200.2)</b>			
Lead	BRL	1.00		ug/L	242782	1	05/18/2017 02:33	JR

**Qualifiers:**

- \* Value exceeds maximum contaminant level
- BRL Below reporting limit
- H Holding times for preparation or analysis exceeded
- N Analyte not NELAC certified
- B Analyte detected in the associated method blank
- > Greater than Result value

- E Estimated (value above quantitation range)
- S Spike Recovery outside limits due to matrix
- Narr See case narrative
- NC Not confirmed
- < Less than Result value
- J Estimated value detected below Reporting Limit

### SAMPLE/COOLER RECEIPT CHECKLIST

1. Client Name: \_\_\_\_\_

AES Work Order Number: \_\_\_\_\_

2. Carrier: FedEx  UPS  USPS  Client  Courier  Other \_\_\_\_\_

	Yes	No	N/A	Details	Comments
3. Shipping container/cooler received in good condition?				damaged <input type="checkbox"/> leaking <input type="checkbox"/> other <input type="checkbox"/>	
4. Custody seals present on shipping container?					
5. Custody seals intact on shipping container?					
6. Temperature blanks present?					
7. Cooler temperature(s) within limits of 0-6°C? [See item 13 and 14 for temperature recordings.]				Cooling initiated for recently collected samples / ice present <input type="checkbox"/>	
8. Chain of Custody (COC) present?					
9. Chain of Custody signed, dated, and timed when relinquished and received?					
10. Sampler name and/or signature on COC?					
11. Were all samples received within holding time?					
12. TAT marked on the COC?				If no TAT indicated, proceeded with standard TAT per Terms & Conditions. <input type="checkbox"/>	

13. Cooler 1 Temperature \_\_\_\_\_ °C    Cooler 2 Temperature \_\_\_\_\_ °C    Cooler 3 Temperature \_\_\_\_\_ °C    Cooler 4 Temperature \_\_\_\_\_ °C  
 Cooler 5 Temperature \_\_\_\_\_ °C    Cooler 6 Temperature \_\_\_\_\_ °C    Cooler 7 Temperature \_\_\_\_\_ °C    Cooler 8 Temperature \_\_\_\_\_ °C

15. Comments: \_\_\_\_\_

I certify that I have completed sections 1-15 (dated initials). \_\_\_\_\_

	Yes	No	N/A	Details	Comments
16. Were sample containers intact upon receipt?					
17. Custody seals present on sample containers?					
18. Custody seals intact on sample containers?					
19. Do sample container labels match the COC?				incomplete info <input type="checkbox"/> illegible <input type="checkbox"/> no label <input type="checkbox"/> other <input type="checkbox"/>	
20. Are analyses requested indicated on the COC?					
21. Were all of the samples listed on the COC received?				samples received but not listed on COC <input type="checkbox"/> samples listed on COC not received <input type="checkbox"/>	
22. Was the sample collection date/time noted?					
23. Did we receive sufficient sample volume for indicated analyses?					
24. Were samples received in appropriate containers?					
25. Were VOA samples received without headspace (< 1/4" bubble)?					
26. Were trip blanks submitted?				listed on COC <input type="checkbox"/> not listed on COC <input type="checkbox"/>	

27. Comments: \_\_\_\_\_

I certify that I have completed sections 16-27 (dated initials). \_\_\_\_\_

	Yes	No	N/A	Details	Comments
28. Have containers needing chemical preservation been checked?					
29. Containers meet preservation guidelines?					
30. Was pH adjusted?					

I certify that I have completed sections 28-30 (dated initials). \_\_\_\_\_

**Client:** Atlanta Environmental Mgmt  
**Project Name:** DCSD - 0193  
**Workorder:** 1705525

**ANALYTICAL QC SUMMARY REPORT**

**BatchID: 242777**

Sample ID: <b>MB-242777</b>	Client ID:	Units: <b>ug/L</b>	Prep Date: <b>05/17/2017</b>	Run No: <b>343397</b>							
SampleType: <b>MBLK</b>	TestCode: <b>Trace Elements by ICP/MS E200.8</b>	BatchID: <b>242777</b>	Analysis Date: <b>05/17/2017</b>	Seq No: <b>7528537</b>							
Analyte	Result	RPT Limit	SPK value	SPK Ref Val	%REC	Low Limit	High Limit	RPD Ref Val	%RPD	RPD Limit	Qual

Lead BRL 1.00

Sample ID: <b>LCS-242777</b>	Client ID:	Units: <b>ug/L</b>	Prep Date: <b>05/17/2017</b>	Run No: <b>343397</b>							
SampleType: <b>LCS</b>	TestCode: <b>Trace Elements by ICP/MS E200.8</b>	BatchID: <b>242777</b>	Analysis Date: <b>05/17/2017</b>	Seq No: <b>7528538</b>							
Analyte	Result	RPT Limit	SPK value	SPK Ref Val	%REC	Low Limit	High Limit	RPD Ref Val	%RPD	RPD Limit	Qual

Lead 97.86 1.00 100.0 97.9 85 115

Sample ID: <b>1705525-001AMS</b>	Client ID: <b>0193-050517-DF-001-A</b>	Units: <b>ug/L</b>	Prep Date: <b>05/17/2017</b>	Run No: <b>343397</b>							
SampleType: <b>MS</b>	TestCode: <b>Trace Elements by ICP/MS E200.8</b>	BatchID: <b>242777</b>	Analysis Date: <b>05/17/2017</b>	Seq No: <b>7528540</b>							
Analyte	Result	RPT Limit	SPK value	SPK Ref Val	%REC	Low Limit	High Limit	RPD Ref Val	%RPD	RPD Limit	Qual

Lead 96.67 1.00 100.0 96.7 70 130

Sample ID: <b>1705525-011AMS</b>	Client ID: <b>0193-050517-DF-005-B</b>	Units: <b>ug/L</b>	Prep Date: <b>05/17/2017</b>	Run No: <b>343397</b>							
SampleType: <b>MS</b>	TestCode: <b>Trace Elements by ICP/MS E200.8</b>	BatchID: <b>242777</b>	Analysis Date: <b>05/17/2017</b>	Seq No: <b>7528543</b>							
Analyte	Result	RPT Limit	SPK value	SPK Ref Val	%REC	Low Limit	High Limit	RPD Ref Val	%RPD	RPD Limit	Qual

Lead 96.40 1.00 100.0 96.4 70 130

Sample ID: <b>1705525-001AMSD</b>	Client ID: <b>0193-050517-DF-001-A</b>	Units: <b>ug/L</b>	Prep Date: <b>05/17/2017</b>	Run No: <b>343397</b>							
SampleType: <b>MSD</b>	TestCode: <b>Trace Elements by ICP/MS E200.8</b>	BatchID: <b>242777</b>	Analysis Date: <b>05/17/2017</b>	Seq No: <b>7528541</b>							
Analyte	Result	RPT Limit	SPK value	SPK Ref Val	%REC	Low Limit	High Limit	RPD Ref Val	%RPD	RPD Limit	Qual

Lead 97.85 1.00 100.0 97.8 70 130 96.67 1.21 20

**Qualifiers:** > Greater than Result value < Less than Result value B Analyte detected in the associated method blank  
 BRL Below reporting limit E Estimated (value above quantitation range) H Holding times for preparation or analysis exceeded  
 J Estimated value detected below Reporting Limit N Analyte not NELAC certified R RPD outside limits due to matrix  
 Rpt Lim Reporting Limit S Spike Recovery outside limits due to matrix

**Client:** Atlanta Environmental Mgmt  
**Project Name:** DCSD - 0193  
**Workorder:** 1705525

**ANALYTICAL QC SUMMARY REPORT**

**BatchID: 242778**

Sample ID: <b>MB-242778</b>	Client ID:	Units: <b>ug/L</b>	Prep Date: <b>05/17/2017</b>	Run No: <b>343398</b>							
SampleType: <b>MBLK</b>	TestCode: <b>Trace Elements by ICP/MS E200.8</b>	BatchID: <b>242778</b>	Analysis Date: <b>05/17/2017</b>	Seq No: <b>7528854</b>							
Analyte	Result	RPT Limit	SPK value	SPK Ref Val	%REC	Low Limit	High Limit	RPD Ref Val	%RPD	RPD Limit	Qual

Lead BRL 1.00

Sample ID: <b>LCS-242778</b>	Client ID:	Units: <b>ug/L</b>	Prep Date: <b>05/17/2017</b>	Run No: <b>343398</b>							
SampleType: <b>LCS</b>	TestCode: <b>Trace Elements by ICP/MS E200.8</b>	BatchID: <b>242778</b>	Analysis Date: <b>05/17/2017</b>	Seq No: <b>7528855</b>							
Analyte	Result	RPT Limit	SPK value	SPK Ref Val	%REC	Low Limit	High Limit	RPD Ref Val	%RPD	RPD Limit	Qual

Lead 101.8 1.00 100.0 102 85 115

Sample ID: <b>1705525-021AMS</b>	Client ID: <b>0193-050517-DF-010-B</b>	Units: <b>ug/L</b>	Prep Date: <b>05/17/2017</b>	Run No: <b>343398</b>							
SampleType: <b>MS</b>	TestCode: <b>Trace Elements by ICP/MS E200.8</b>	BatchID: <b>242778</b>	Analysis Date: <b>05/17/2017</b>	Seq No: <b>7528859</b>							
Analyte	Result	RPT Limit	SPK value	SPK Ref Val	%REC	Low Limit	High Limit	RPD Ref Val	%RPD	RPD Limit	Qual

Lead 97.54 1.00 100.0 97.5 70 130

Sample ID: <b>1705525-031AMS</b>	Client ID: <b>0193-050517-DF-015-B</b>	Units: <b>ug/L</b>	Prep Date: <b>05/17/2017</b>	Run No: <b>343398</b>							
SampleType: <b>MS</b>	TestCode: <b>Trace Elements by ICP/MS E200.8</b>	BatchID: <b>242778</b>	Analysis Date: <b>05/17/2017</b>	Seq No: <b>7528869</b>							
Analyte	Result	RPT Limit	SPK value	SPK Ref Val	%REC	Low Limit	High Limit	RPD Ref Val	%RPD	RPD Limit	Qual

Lead 102.8 1.00 100.0 0.3585 102 70 130

Sample ID: <b>1705525-021AMSD</b>	Client ID: <b>0193-050517-DF-010-B</b>	Units: <b>ug/L</b>	Prep Date: <b>05/17/2017</b>	Run No: <b>343398</b>							
SampleType: <b>MSD</b>	TestCode: <b>Trace Elements by ICP/MS E200.8</b>	BatchID: <b>242778</b>	Analysis Date: <b>05/17/2017</b>	Seq No: <b>7528861</b>							
Analyte	Result	RPT Limit	SPK value	SPK Ref Val	%REC	Low Limit	High Limit	RPD Ref Val	%RPD	RPD Limit	Qual

Lead 108.4 1.00 100.0 108 70 130 97.54 10.5 20

<b>Qualifiers:</b>	> Greater than Result value	< Less than Result value	B Analyte detected in the associated method blank
	BRL Below reporting limit	E Estimated (value above quantitation range)	H Holding times for preparation or analysis exceeded
	J Estimated value detected below Reporting Limit	N Analyte not NELAC certified	R RPD outside limits due to matrix
	Rpt Lim Reporting Limit	S Spike Recovery outside limits due to matrix	

Client: Atlanta Environmental Mgmt  
 Project Name: DCSD - 0193  
 Workorder: 1705525

**ANALYTICAL QC SUMMARY REPORT**

BatchID: 242779

Sample ID: <b>MB-242779</b>	Client ID:	Units: <b>ug/L</b>	Prep Date: <b>05/17/2017</b>	Run No: <b>343399</b>							
SampleType: <b>MBLK</b>	TestCode: <b>Trace Elements by ICP/MS E200.8</b>	BatchID: <b>242779</b>	Analysis Date: <b>05/17/2017</b>	Seq No: <b>7528920</b>							
Analyte	Result	RPT Limit	SPK value	SPK Ref Val	%REC	Low Limit	High Limit	RPD Ref Val	%RPD	RPD Limit	Qual

Lead BRL 1.00

Sample ID: <b>LCS-242779</b>	Client ID:	Units: <b>ug/L</b>	Prep Date: <b>05/17/2017</b>	Run No: <b>343399</b>							
SampleType: <b>LCS</b>	TestCode: <b>Trace Elements by ICP/MS E200.8</b>	BatchID: <b>242779</b>	Analysis Date: <b>05/17/2017</b>	Seq No: <b>7528921</b>							
Analyte	Result	RPT Limit	SPK value	SPK Ref Val	%REC	Low Limit	High Limit	RPD Ref Val	%RPD	RPD Limit	Qual

Lead 109.9 1.00 100.0 110 85 115

Sample ID: <b>1705525-041AMS</b>	Client ID: <b>0193-050517-OT-004-B</b>	Units: <b>ug/L</b>	Prep Date: <b>05/17/2017</b>	Run No: <b>343399</b>							
SampleType: <b>MS</b>	TestCode: <b>Trace Elements by ICP/MS E200.8</b>	BatchID: <b>242779</b>	Analysis Date: <b>05/17/2017</b>	Seq No: <b>7528923</b>							
Analyte	Result	RPT Limit	SPK value	SPK Ref Val	%REC	Low Limit	High Limit	RPD Ref Val	%RPD	RPD Limit	Qual

Lead 100.9 1.00 100.0 101 70 130

Sample ID: <b>1705525-051AMS</b>	Client ID: <b>0193-050517-CS-003-A</b>	Units: <b>ug/L</b>	Prep Date: <b>05/17/2017</b>	Run No: <b>343399</b>							
SampleType: <b>MS</b>	TestCode: <b>Trace Elements by ICP/MS E200.8</b>	BatchID: <b>242779</b>	Analysis Date: <b>05/17/2017</b>	Seq No: <b>7528926</b>							
Analyte	Result	RPT Limit	SPK value	SPK Ref Val	%REC	Low Limit	High Limit	RPD Ref Val	%RPD	RPD Limit	Qual

Lead 110.1 1.00 100.0 2.609 107 70 130

Sample ID: <b>1705525-041AMSD</b>	Client ID: <b>0193-050517-OT-004-B</b>	Units: <b>ug/L</b>	Prep Date: <b>05/17/2017</b>	Run No: <b>343399</b>							
SampleType: <b>MSD</b>	TestCode: <b>Trace Elements by ICP/MS E200.8</b>	BatchID: <b>242779</b>	Analysis Date: <b>05/17/2017</b>	Seq No: <b>7528924</b>							
Analyte	Result	RPT Limit	SPK value	SPK Ref Val	%REC	Low Limit	High Limit	RPD Ref Val	%RPD	RPD Limit	Qual

Lead 101.8 1.00 100.0 102 70 130 100.9 0.797 20

<b>Qualifiers:</b>	> Greater than Result value	< Less than Result value	B Analyte detected in the associated method blank
	BRL Below reporting limit	E Estimated (value above quantitation range)	H Holding times for preparation or analysis exceeded
	J Estimated value detected below Reporting Limit	N Analyte not NELAC certified	R RPD outside limits due to matrix
	Rpt Lim Reporting Limit	S Spike Recovery outside limits due to matrix	

**Client:** Atlanta Environmental Mgmt  
**Project Name:** DCSD - 0193  
**Workorder:** 1705525

**ANALYTICAL QC SUMMARY REPORT**

**BatchID: 242782**

Sample ID: <b>MB-242782</b>	Client ID:	Units: <b>ug/L</b>	Prep Date: <b>05/17/2017</b>	Run No: <b>343400</b>							
SampleType: <b>MBLK</b>	TestCode: <b>Trace Elements by ICP/MS E200.8</b>	BatchID: <b>242782</b>	Analysis Date: <b>05/18/2017</b>	Seq No: <b>7528984</b>							
Analyte	Result	RPT Limit	SPK value	SPK Ref Val	%REC	Low Limit	High Limit	RPD Ref Val	%RPD	RPD Limit	Qual

Lead BRL 1.00

Sample ID: <b>LCS-242782</b>	Client ID:	Units: <b>ug/L</b>	Prep Date: <b>05/17/2017</b>	Run No: <b>343400</b>							
SampleType: <b>LCS</b>	TestCode: <b>Trace Elements by ICP/MS E200.8</b>	BatchID: <b>242782</b>	Analysis Date: <b>05/18/2017</b>	Seq No: <b>7530893</b>							
Analyte	Result	RPT Limit	SPK value	SPK Ref Val	%REC	Low Limit	High Limit	RPD Ref Val	%RPD	RPD Limit	Qual

Lead 96.03 1.00 100.0 96.0 85 115

Sample ID: <b>1705525-066AMS</b>	Client ID: <b>0193-050517-TL-003-B</b>	Units: <b>ug/L</b>	Prep Date: <b>05/17/2017</b>	Run No: <b>343400</b>							
SampleType: <b>MS</b>	TestCode: <b>Trace Elements by ICP/MS E200.8</b>	BatchID: <b>242782</b>	Analysis Date: <b>05/18/2017</b>	Seq No: <b>7528987</b>							
Analyte	Result	RPT Limit	SPK value	SPK Ref Val	%REC	Low Limit	High Limit	RPD Ref Val	%RPD	RPD Limit	Qual

Lead 108.8 1.00 100.0 109 70 130

Sample ID: <b>1705896-104AMS</b>	Client ID:	Units: <b>ug/L</b>	Prep Date: <b>05/17/2017</b>	Run No: <b>343400</b>							
SampleType: <b>MS</b>	TestCode: <b>Trace Elements by ICP/MS E200.8</b>	BatchID: <b>242782</b>	Analysis Date: <b>05/18/2017</b>	Seq No: <b>7528992</b>							
Analyte	Result	RPT Limit	SPK value	SPK Ref Val	%REC	Low Limit	High Limit	RPD Ref Val	%RPD	RPD Limit	Qual

Lead 105.6 1.00 100.0 106 70 130

Sample ID: <b>1705525-066AMSD</b>	Client ID: <b>0193-050517-TL-003-B</b>	Units: <b>ug/L</b>	Prep Date: <b>05/17/2017</b>	Run No: <b>343400</b>							
SampleType: <b>MSD</b>	TestCode: <b>Trace Elements by ICP/MS E200.8</b>	BatchID: <b>242782</b>	Analysis Date: <b>05/18/2017</b>	Seq No: <b>7528988</b>							
Analyte	Result	RPT Limit	SPK value	SPK Ref Val	%REC	Low Limit	High Limit	RPD Ref Val	%RPD	RPD Limit	Qual

Lead 109.5 1.00 100.0 110 70 130 108.8 0.645 20

**Qualifiers:** > Greater than Result value < Less than Result value B Analyte detected in the associated method blank  
 BRL Below reporting limit E Estimated (value above quantitation range) H Holding times for preparation or analysis exceeded  
 J Estimated value detected below Reporting Limit N Analyte not NELAC certified R RPD outside limits due to matrix  
 Rpt Lim Reporting Limit S Spike Recovery outside limits due to matrix

## Leona Miles

---

**From:** NoReply@aesatlanta.net  
**Sent:** Thursday, November 9, 2017 2:25 PM  
**To:** leona-miles@aem-net.com; tim-royer@aem-net.com  
**Subject:** DCSD - 0193  
**Attachments:** 1710R25\_REPORT.pdf; 1710R25Invoice.pdf

Please see attached. If you have any questions or need further assistance please contact your project manager at 770-457-8177.

AES Reporting System

ANALYTICAL ENVIRONMENTAL SERVICES, INC.  
3080 Presidential Drive ATLANTA, GA 30340  
Tel:770-457-8177 Fax:770-457-8188  
<http://www.aesatlanta.com>

NOTICE OF CONFIDENTIALITY: The information in this email and / or attachments may be legally privileged and is confidential information intended for the use of the individual or entity named in the email address. If the reader of this message is not the intended recipient, you are hereby notified that any use, dissemination, distribution, or copy of this email and / or attachments is strictly prohibited. If you have received this email in error, please notify Analytical Environmental Services Customer Service by telephone at (770) 457-8177 or by email at [info@aesatlanta.com](mailto:info@aesatlanta.com) <<mailto:info@aesatlanta.com>> and delete the message. Thank you





**ANALYTICAL ENVIRONMENTAL SERVICES, INC.**

November 09, 2017

Leona Miles  
Atlanta Environmental Mgmt  
2580 NE Expressway  
Atlanta GA 30345

RE: DCSD - 0193

Dear Leona Miles:

Order No: 1710R25

Analytical Environmental Services, Inc. received 2 samples on 10/27/2017 10:15:00 AM for the analyses presented in following report.

No problems were encountered during the analyses. Additionally, all results for the associated Quality Control samples were within EPA and/or AES established limits. Any discrepancies associated with the analyses contained herein will be noted and submitted in the form of a project Case Narrative.

AES's accreditations are as follows:

-NELAP/State of Florida Laboratory ID E87582 for analysis of Non-Potable Water, Solid & Chemical Materials, Air & Emissions Volatile Organics, and Drinking Water Microbiology & Metals, effective 07/01/17-06/30/18.

State of Georgia, Department of Natural Resources ID #800 for analysis of Drinking Water Metals, effective 07/01/17-06/30/18 and Total Coliforms/ E. coli, effective 04/25/17-04/24/20.

-NELAP/Louisiana Agency Interest No. 100818 for or analysis of Non-Potable Water and Solid & Chemical Materials, effective 07/01/17-06/30/18.

-AIHA-LAP, LLC Laboratory ID: 100671 for Industrial Hygiene samples (Organics, Metals, PCM Asbestos, Gravimetric), Environmental Lead (Paint, Soil, Dust Wipes, Air), and Environmental Microbiology (Fungal) Direct Examination, effective until 12/01/17.

These results relate only to the items tested. This report may only be reproduced in full.

If you have any questions regarding these test results, please feel free to call.

Sincerely,

Ioana Pacurar  
Project Manager



COMPANY: <b>Atlanta Environmental Management Inc</b>		ADDRESS: <b>2580 Northeast Expressway NE Atlanta, GA 30345</b>					ANALYSIS REQUESTED							Visit our website <a href="http://www.aesatlanta.com">www.aesatlanta.com</a> to check on the status of your results, place bottle orders, etc.		No # of Containers
PHONE: 404-329-9006		FAX: 404-329-2057					Lead (200.8)									
SAMPLED BY: Leona Miles		SIGNATURE: <i>Leona Miles</i>						PRESERVATION (See codes)							REMARKS	
#	SAMPLE ID	SAMPLED		Grab	Composite	Matrix (See codes)										
		DATE	TIME													
1	0193-102717-TL-002-A	10/27/2017	0519	X		DW	X									
2	0193-102717-TL-002-B	10/27/2017	0520	X		DW	X									
3																
4																
5																
6																
7																
8																
9																
10																
11																
12																
13																
14																
15																
REINQUISHED BY		DATE/TIME	RECEIVED BY		DATE/TIME	PROJECT INFORMATION							RECEIPT			
1: <i>Leona Miles</i>		10/27/17 1015	1: <i>Leona Miles</i>		10/27/17 1015	PROJECT NAME: DCS							Total # of Containers			
2:			2: <i>[Signature]</i>			PROJECT #: 1561-1601							<input type="radio"/> Turnaround Time Request <input type="radio"/> Standard 5 Business Days <input type="radio"/> 2 Business Day Rush <input type="radio"/> Next Business Day Rush <input type="radio"/> Same Day Rush (auth req.) <input checked="" type="radio"/> Other: 10 business Days			
3:			3:			SITE ADDRESS: 0193										
SPECIAL INSTRUCTIONS/COMMENTS:		SHIPMENT METHOD		SEND REPORT TO: <a href="mailto:leona-miles@aem-net.com">leona-miles@aem-net.com</a>							STATE PROGRAM (if any): _____					
Lab to preserve		OUT / / VIA:		INVOICE TO: Leona Miles							E-mail? Y/N; Fax? Y/N					
		IN / / VIA:		(IF DIFFERENT FROM ABOVE)							DATA PACKAGE: I II III IV					
		CLIENT FedEx UPS MAIL COURIER		QUOTE #: _____ PO#: _____												
		GREYHOUND OTHER _____														

SAMPLES RECEIVED AFTER 3PM OR SATURDAY ARE CONSIDERED AS RECEIVED ON THE NEXT BUSINESS DAY; IF NO TAT IS MARKED ON COC AES WILL PROCEED AS STANDARD TAT.  
SAMPLES ARE DISPOSED OF 30 DAYS AFTER COMPLETION OF REPORT UNLESS OTHER ARRANGEMENTS ARE MADE.

MATRIX CODES: A = Air GW = Groundwater SE = Sediment SO = Soil SW = Surface Water DW = Drinking Water W = Water (Blanks) O = Other (specify)  
PRESERVATIVE CODES: H+I = Hydrochloric acid + ice I = Ice only N = Nitric acid S+I = Sulfuric acid + ice S/M+I = Sodium Bisulfate/Methanol + ice O = Other (specify) NA = None

**Analytical Environmental Services, Inc**

**Date:** 9-Nov-17

<b>Client:</b> Atlanta Environmental Mgmt	<b>Client Sample ID:</b> 0193-102717-TL-002-A
<b>Project Name:</b> DCSD - 0193	<b>Collection Date:</b> 10/27/2017 5:19:00 AM
<b>Lab ID:</b> 1710R25-001	<b>Matrix:</b> Drinking Water

Analyses	Result	Reporting Limit	Qual	Units	BatchID	Dilution Factor	Date Analyzed	Analyst
<b>Trace Elements by ICP/MS E200.8</b>								
					<b>(E200.2)</b>			
Lead	1.31	1.00		ug/L	250906	1	11/07/2017 13:49	TA

**Qualifiers:**

- \* Value exceeds maximum contaminant level
- BRL Below reporting limit
- H Holding times for preparation or analysis exceeded
- N Analyte not NELAC certified
- B Analyte detected in the associated method blank
- > Greater than Result value

- E Estimated (value above quantitation range)
- S Spike Recovery outside limits due to matrix
- Narr See case narrative
- NC Not confirmed
- < Less than Result value
- J Estimated value detected below Reporting Limit

**Analytical Environmental Services, Inc**

**Date:** 9-Nov-17

<b>Client:</b> Atlanta Environmental Mgmt	<b>Client Sample ID:</b> 0193-102717-TL-002-B
<b>Project Name:</b> DCSD - 0193	<b>Collection Date:</b> 10/27/2017 5:20:00 AM
<b>Lab ID:</b> 1710R25-002	<b>Matrix:</b> Drinking Water

Analyses	Result	Reporting Limit	Qual	Units	BatchID	Dilution Factor	Date Analyzed	Analyst
<b>Trace Elements by ICP/MS E200.8</b>					<b>(E200.2)</b>			
Lead	BRL	1.00		ug/L	250906	1	11/07/2017 13:51	TA

**Qualifiers:**

- \* Value exceeds maximum contaminant level
- BRL Below reporting limit
- H Holding times for preparation or analysis exceeded
- N Analyte not NELAC certified
- B Analyte detected in the associated method blank
- > Greater than Result value

- E Estimated (value above quantitation range)
- S Spike Recovery outside limits due to matrix
- Narr See case narrative
- NC Not confirmed
- < Less than Result value
- J Estimated value detected below Reporting Limit

### SAMPLE/COOLER RECEIPT CHECKLIST

1. Client Name: \_\_\_\_\_

AES Work Order Number: \_\_\_\_\_

2. Carrier: FedEx  UPS  USPS  Client  Courier  Other \_\_\_\_\_

	Yes	No	N/A	Details	Comments
3. Shipping container/cooler received in good condition?				damaged <input type="checkbox"/> leaking <input type="checkbox"/> other <input type="checkbox"/>	
4. Custody seals present on shipping container?					
5. Custody seals intact on shipping container?					
6. Temperature blanks present?					
7. Cooler temperature(s) within limits of 0-6°C? [See item 13 and 14 for temperature recordings.]				Cooling initiated for recently collected samples / ice present <input type="checkbox"/>	
8. Chain of Custody (COC) present?					
9. Chain of Custody signed, dated, and timed when relinquished and received?					
10. Sampler name and/or signature on COC?					
11. Were all samples received within holding time?					
12. TAT marked on the COC?				If no TAT indicated, proceeded with standard TAT per Terms & Conditions. <input type="checkbox"/>	

13. Cooler 1 Temperature \_\_\_\_\_ °C    Cooler 2 Temperature \_\_\_\_\_ °C    Cooler 3 Temperature \_\_\_\_\_ °C    Cooler 4 Temperature \_\_\_\_\_ °C  
 Cooler 5 Temperature \_\_\_\_\_ °C    Cooler 6 Temperature \_\_\_\_\_ °C    Cooler 7 Temperature \_\_\_\_\_ °C    Cooler 8 Temperature \_\_\_\_\_ °C

15. Comments: \_\_\_\_\_

I certify that I have completed sections 1-15 (dated initials). \_\_\_\_\_

	Yes	No	N/A	Details	Comments
16. Were sample containers intact upon receipt?					
17. Custody seals present on sample containers?					
18. Custody seals intact on sample containers?					
19. Do sample container labels match the COC?				incomplete info <input type="checkbox"/> illegible <input type="checkbox"/> no label <input type="checkbox"/> other <input type="checkbox"/>	
20. Are analyses requested indicated on the COC?					
21. Were all of the samples listed on the COC received?				samples received but not listed on COC <input type="checkbox"/> samples listed on COC not received <input type="checkbox"/>	
22. Was the sample collection date/time noted?					
23. Did we receive sufficient sample volume for indicated analyses?					
24. Were samples received in appropriate containers?					
25. Were VOA samples received without headspace (< 1/4" bubble)?					
26. Were trip blanks submitted?				listed on COC <input type="checkbox"/> not listed on COC <input type="checkbox"/>	

27. Comments: \_\_\_\_\_

I certify that I have completed sections 16-27 (dated initials). \_\_\_\_\_

	Yes	No	N/A	Details	Comments
28. Have containers needing chemical preservation been checked? *					
29. Containers meet preservation guidelines?					
30. Was pH adjusted at Sample Receipt?					

I certify that I have completed sections 28-30 (dated initials). \_\_\_\_\_

Client: Atlanta Environmental Mgmt  
 Project Name: DCSD - 0193  
 Workorder: 1710R25

**ANALYTICAL QC SUMMARY REPORT**

BatchID: 250906

Sample ID: <b>MB-250906</b>	Client ID:	Units: <b>ug/L</b>	Prep Date: <b>11/02/2017</b>	Run No: <b>356276</b>							
SampleType: <b>MBLK</b>	TestCode: <b>Trace Elements by ICP/MS E200.8</b>	BatchID: <b>250906</b>	Analysis Date: <b>11/07/2017</b>	Seq No: <b>7848889</b>							
Analyte	Result	RPT Limit	SPK value	SPK Ref Val	%REC	Low Limit	High Limit	RPD Ref Val	%RPD	RPD Limit	Qual

Lead BRL 1.00

Sample ID: <b>LCS-250906</b>	Client ID:	Units: <b>ug/L</b>	Prep Date: <b>11/02/2017</b>	Run No: <b>356276</b>							
SampleType: <b>LCS</b>	TestCode: <b>Trace Elements by ICP/MS E200.8</b>	BatchID: <b>250906</b>	Analysis Date: <b>11/07/2017</b>	Seq No: <b>7848890</b>							
Analyte	Result	RPT Limit	SPK value	SPK Ref Val	%REC	Low Limit	High Limit	RPD Ref Val	%RPD	RPD Limit	Qual

Lead 88.32 1.00 100.0 88.3 85 115

Sample ID: <b>1710R23-001AMS</b>	Client ID:	Units: <b>ug/L</b>	Prep Date: <b>11/02/2017</b>	Run No: <b>356276</b>							
SampleType: <b>MS</b>	TestCode: <b>Trace Elements by ICP/MS E200.8</b>	BatchID: <b>250906</b>	Analysis Date: <b>11/07/2017</b>	Seq No: <b>7848894</b>							
Analyte	Result	RPT Limit	SPK value	SPK Ref Val	%REC	Low Limit	High Limit	RPD Ref Val	%RPD	RPD Limit	Qual

Lead 98.62 1.00 100.0 1.403 97.2 70 130

Sample ID: <b>1710S79-006AMS</b>	Client ID:	Units: <b>ug/L</b>	Prep Date: <b>11/02/2017</b>	Run No: <b>356276</b>							
SampleType: <b>MS</b>	TestCode: <b>Trace Elements by ICP/MS E200.8</b>	BatchID: <b>250906</b>	Analysis Date: <b>11/07/2017</b>	Seq No: <b>7848898</b>							
Analyte	Result	RPT Limit	SPK value	SPK Ref Val	%REC	Low Limit	High Limit	RPD Ref Val	%RPD	RPD Limit	Qual

Lead 97.76 1.00 100.0 97.8 70 130

Sample ID: <b>1710R23-001AMSD</b>	Client ID:	Units: <b>ug/L</b>	Prep Date: <b>11/02/2017</b>	Run No: <b>356276</b>							
SampleType: <b>MSD</b>	TestCode: <b>Trace Elements by ICP/MS E200.8</b>	BatchID: <b>250906</b>	Analysis Date: <b>11/07/2017</b>	Seq No: <b>7848895</b>							
Analyte	Result	RPT Limit	SPK value	SPK Ref Val	%REC	Low Limit	High Limit	RPD Ref Val	%RPD	RPD Limit	Qual

Lead 108.1 1.00 100.0 1.403 107 70 130 98.62 9.14 20

**Qualifiers:** > Greater than Result value < Less than Result value B Analyte detected in the associated method blank  
 BRL Below reporting limit E Estimated (value above quantitation range) H Holding times for preparation or analysis exceeded  
 J Estimated value detected below Reporting Limit N Analyte not NELAC certified R RPD outside limits due to matrix  
 Rpt Lim Reporting Limit S Spike Recovery outside limits due to matrix